

CONFIDENTIAL NOTICE: This drawing and the design, specifications and engineering information disclosed herein are the property of Eberhard Manufacturing Company and are not to be disseminated or reproduced without express written consent. The drawing is intended for use only for consideration of the system disclosed herein. In no event shall this drawing, including design, be used for any other purpose without the express written consent of Eberhard Manufacturing Company.

REV	DESCRIPTION	BY	DATE
1	REVISED DRAWING FOR 970	WJH	4/24/13

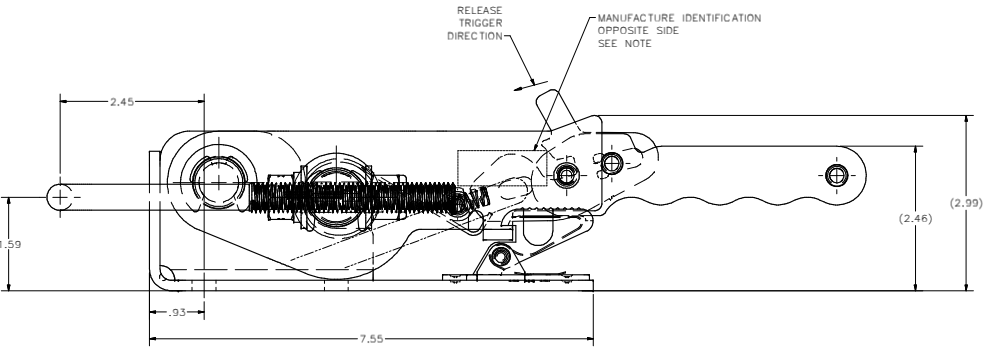
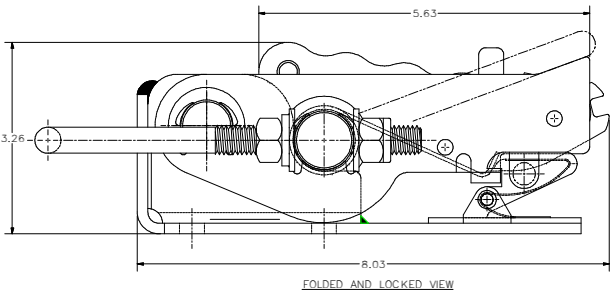
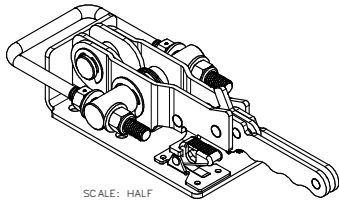
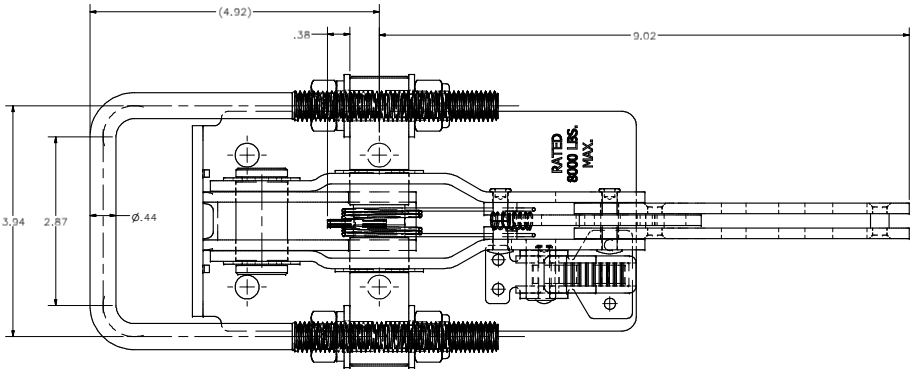
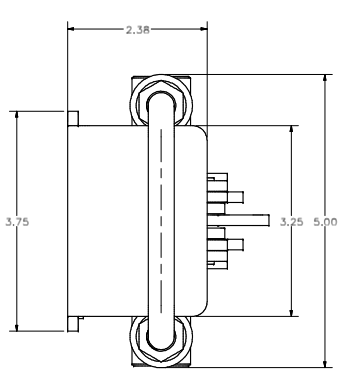
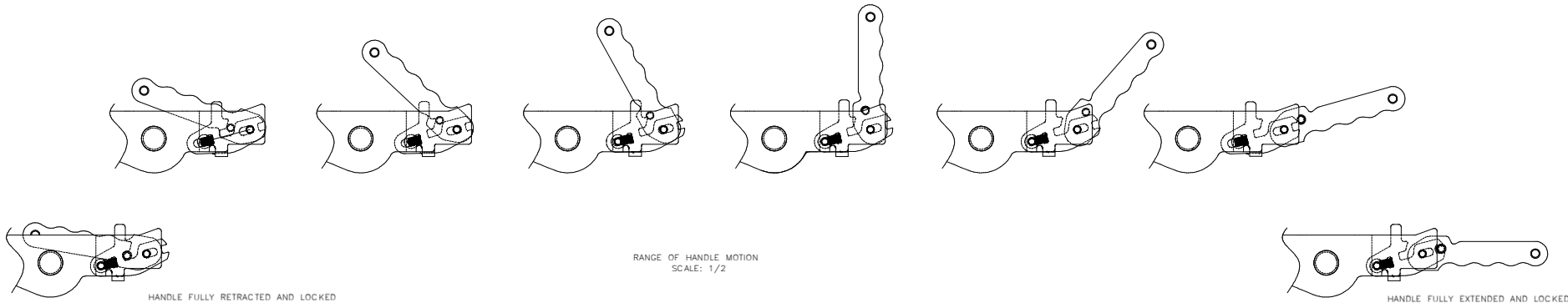

NOTES:
 1. MANUFACTURE IDENTIFICATION STENCIL .120 X .030 DEEP LETTERS.
 TEXT TO READ: "EBERHARD
 CLEVELAND, OHIO
 PATENT PENDING"
 ALTERNATE METHOD: STAMP THE ABOVE TEXT IN PERMANENT WHITE INK.
 2. FINISH: E-COAT, FC (23)

THIS DOCUMENT IS UNCLASSIFIED SINCE DATE 04/23/2013		DRAWING NUMBER	
TOLERANCES ARE AS FOLLOWS:		DIMENSIONS	
1	FRAMES	1	AS SHOWN
2	PLATE THICKNESS	2	SEE NOTE
3	PLATE THICKNESS	3	SEE NOTE
4	ALL OTHERS	4	SEE NOTE

CUSTOMER PRINT
 SHEET 1 OF 2

EBERHARD MANUFACTURING CO.
 DIVISION OF
 THE EASTERN COMPANY
 CLEVELAND, OHIO 44148-8112

HEAVY DUTY DRAW LATCH WITH 7/16" DIA. U-BOLT - FOLDING HANDLE

970

SUPERSEDES DRAWING 970 SHEET 1 OF 2 DATED 9-11-09.

C:\Working_Folder\Active\970\970 SH1.dwg