

CONFIDENTIAL NOTICE: This drawing and the designs, specifications and engineering information disclosed hereon are the property of Eberhard Manufacturing Company and are not to be disseminated or reproduced without express written consent. The drawing is loaned in confidence and then only for consideration of the matter disclosed hereon. In accepting loan of this drawing, recipient agrees to keep it and the matter disclosed hereon in confidence and not to use nor permit their use in any way detrimental to Eberhard Manufacturing Company, Division of the Eastern Company, 21944 Drake Road, Cleveland, Ohio 44149-9712 © 2015 EBERHARD MFG. CO.

REVISION HISTORY					
REV	DESCRIPTION	EN	DATE	REV. BY	APVD. BY
1	RELEASE TO PRODUCTION / REF-PP11490-B	5707	6/12/2015	KAB	MR

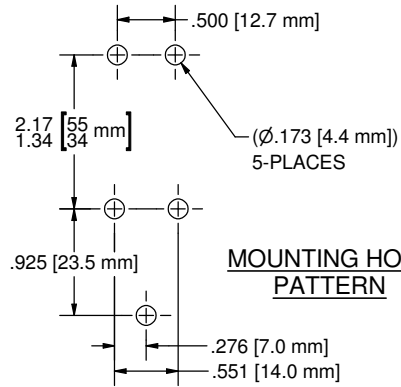
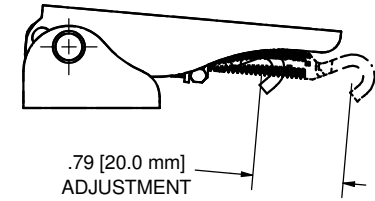
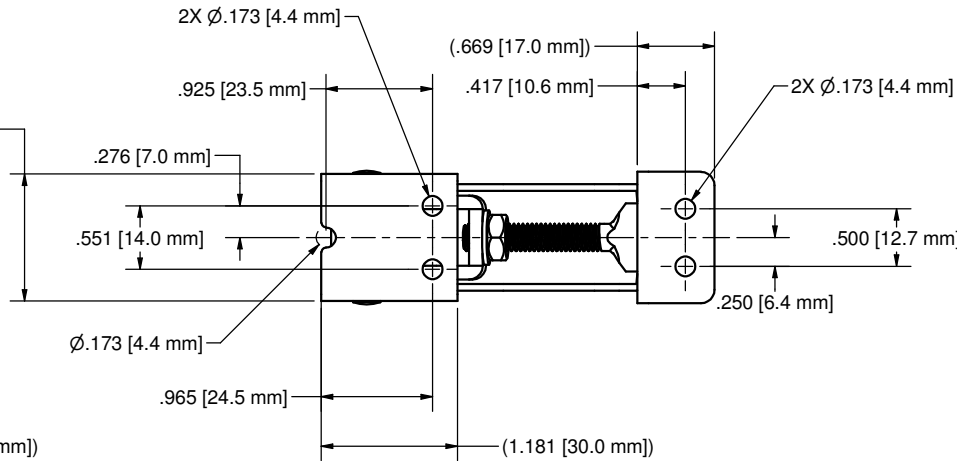
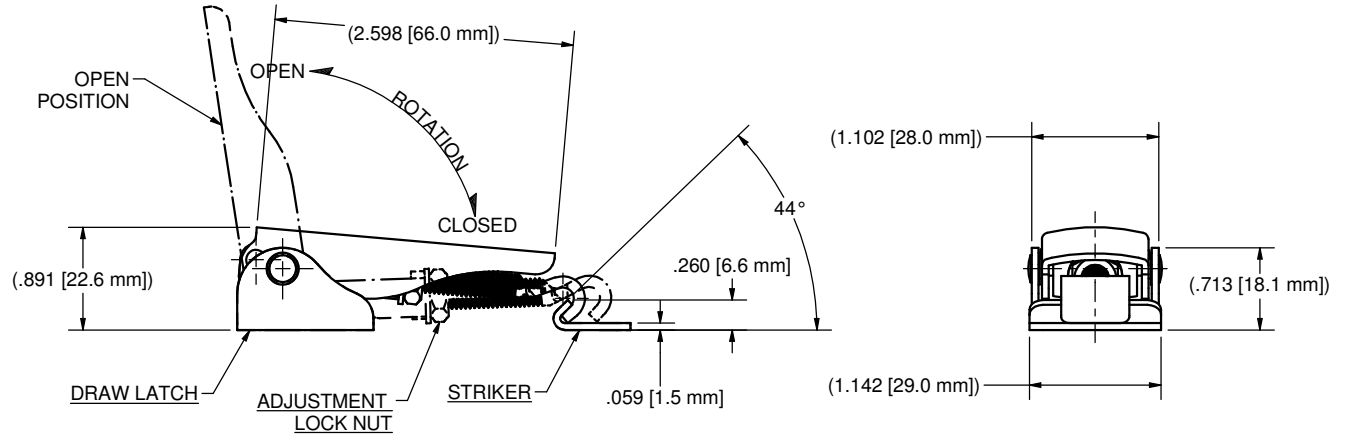
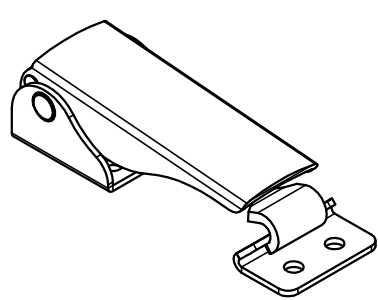

- NOTES:
- 1) MATERIAL: STEEL
 - 2) FINISH: (25) ELECTROPLATED ZINC
 - 3) ORDER PART NUMBER 720-BX25, FOR BOX OF 25.
 - 4) LATCH AND STRIKER TO BE PACKED TOGETHER IN SECURE POLY-BAG.

THIS DOCUMENT IS IN ACCORDANCE WITH ASME Y14.15-2009		
LINEAR MEASURE: INCH(mm)		DATE: 6/12/2015
UNLESS OTHERWISE SPECIFIED TOLERANCES ARE AS FOLLOWS:		
	IN	MM
ANGLES:	$\pm 2'$	$\pm 2'$
2 PLACE DEC.:	$\pm .03$	$\pm .76$
3 PLACE DEC.:	$\pm .015$	$\pm .38$
ALL HOLES:	$\pm .005$	$\pm .13$

EBERHARD MANUFACTURING CO. DIVISION OF THE EASTERN COMPANY CLEVELAND, OHIO 44149-9712	
NAME DRAW LATCH (HIDDEN MOUNT)	
MATERIAL SEE NOTES:	PART NUMBER 720-PK