

CONFIDENTIAL NOTICE: This drawing and the designs, specifications and engineering information disclosed herein are the property of Eberhard Manufacturing Company and are not to be disseminated or reproduced without express written consent. The drawing is loaned in confidence and then only for consideration of the matter disclosed herein. In accepting loan of this drawing, recipient agrees to keep it and the matter disclosed herein in confidence and not to use nor permit their use in any way detrimental to Eberhard Manufacturing Company, Division of the Eastern Company, 21944 Drake Road, Cleveland, Ohio 44149-9712 © 2013 EBERHARD MFG. CO.

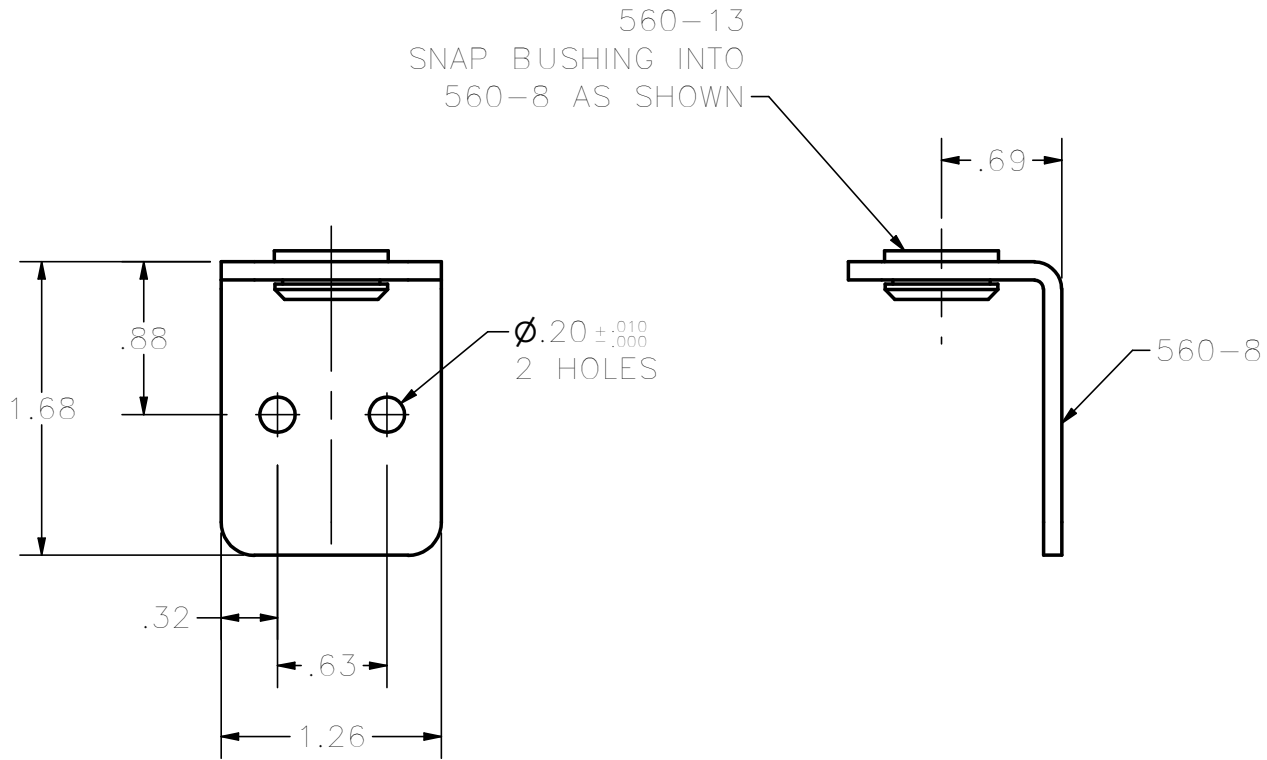

NOTE: USED WITH .31 DIA. ROD.

SUPERSEDES DRAWING 1-560-51 DATED 10-10-94.

LINEAR MEASURE: INCH UNLESS OTHERWISE SPECIFIED TOLERANCES ARE AS FOLLOWS: IN MM ANGLES: ± 2° ± 2° 2 PLACE DEC.: ± .03 ± .76 3 PLACE DEC.: ± .015 ± .38 ALL HOLES: ± .005 ± .13				DATE 2/1/2013	EBERHARD MANUFACTURING CO. DIVISION OF THE EASTERN COMPANY CLEVELAND, OHIO 44149-9712	NAME ROD GUIDE ASSEMBLY	
				DR. BY FLP		MATERIAL -----	PART NUMBER 1-560-51
				SCALE FULL			
				CHK. BY	THIS DOCUMENT IS IN ACCORDANCE WITH ASME Y14.15-2009		
REV	REVISIONS	EN	DATE				