**ES-28500-S****EBERHARD****Whale T-Handle****EM Power Module Kit****Installation Guide****WHALE—T-HANDLE PREP**

Remove BACK BRACKET

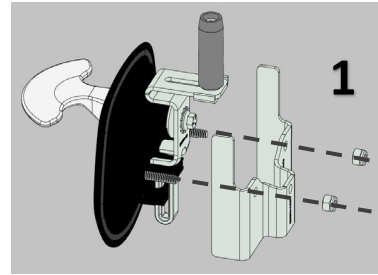

Insert KEY into KEY CYLINDER, and turn to the unlock position.

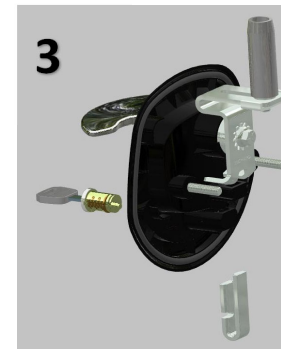
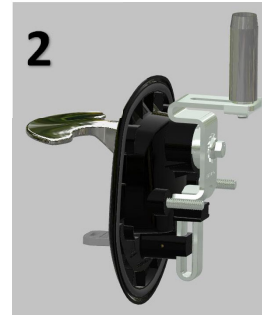

Using the KEY pull-out KEY CYLINDER while depress the RETAINING RING thru the hole on the back of the pan. Slide BOLT out of HOUSING.

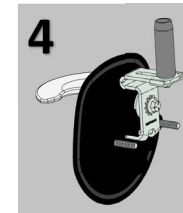
(CAUTION: TUMBLERS WILL FALLOUT IF KEY REMOVED FROM CYLINDER, WHEN NOT IN HOUSING)

Ready for INSTALLTION of EM Power Kit

Tech Support

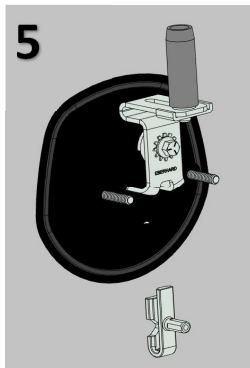
**EM Power Module Kit INSTALLATION**

Slide in BOLT that has the post into HANDLE BODY.

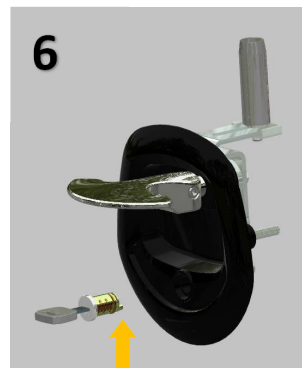
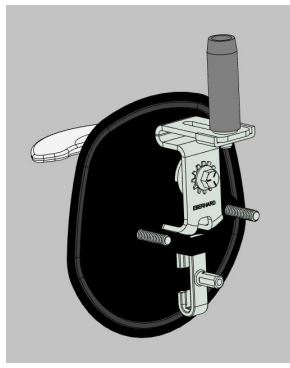

With the KEY inserted in KEY CYLINDER, install the KEY CYLINDER into the HANDLE BODY from the front, while inserting make sure to align PIN on back of CYLINDER and depress RETAINING RING on KEY CYLINER, insert until Cylinder is flush to face of Handle.

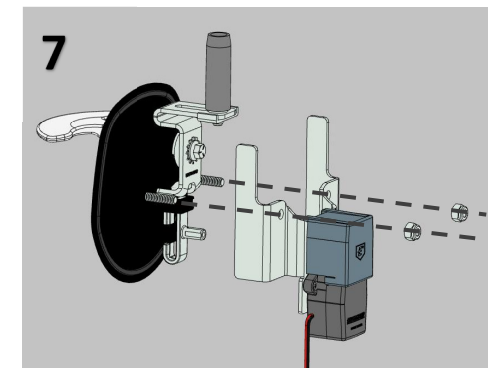
(CAUTION: TUMBLERS WILL FALLOUT IF KEY REMOVED FROM CYLINDER, WHEN NOT IN HOUSING)

Install WHALE-T HANDLE into application from the front, mount the EM POWER MODULE BRACKET ASSEMBLY from the inside of the application with the NUTS.



Tech Support