

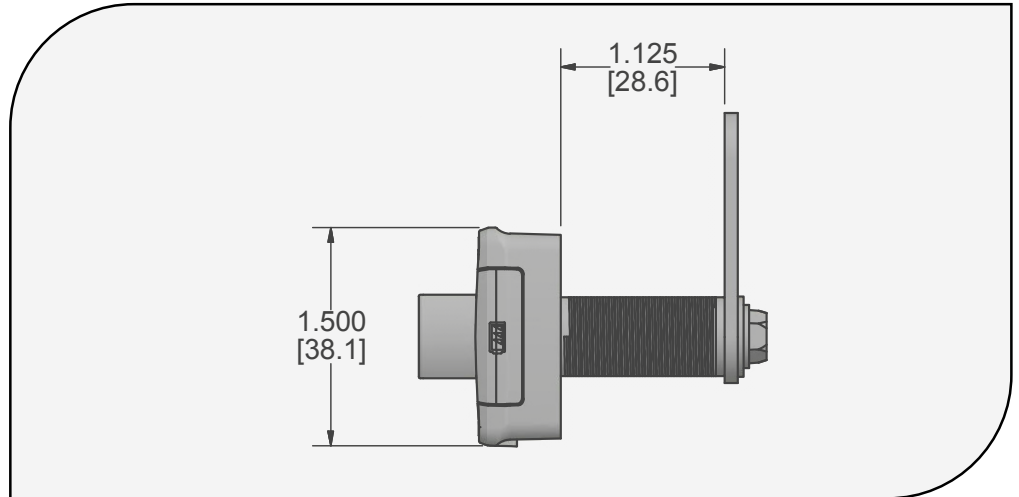

i-LOCK® Electronic Cam Lock

E901

- Fits metal and wood applications up to 7/8" thick
- 4 button electronic touch pad cabinet lock
- Simple touch screen entry
- 1 to 8 digit user defined code
- Two Versions
 - i Standard use - Enter a user code and it remains until reset
 - ii One time use - Enter code to lock and unlock only once
- Button cell battery with up to one year life (CR2032)
- Audible alarm when incorrect code is entered 4 times
- Low power alarm – Audible signal sounds when 200 cycles remain
- Works in any application that has a standard keyed cam lock
- 87,380 possible combinations
- Easy to reset



Horizontal		
Part Number	Use	Color
E901RSS	Standard	Silver
E901R1S	One-Time	Silver

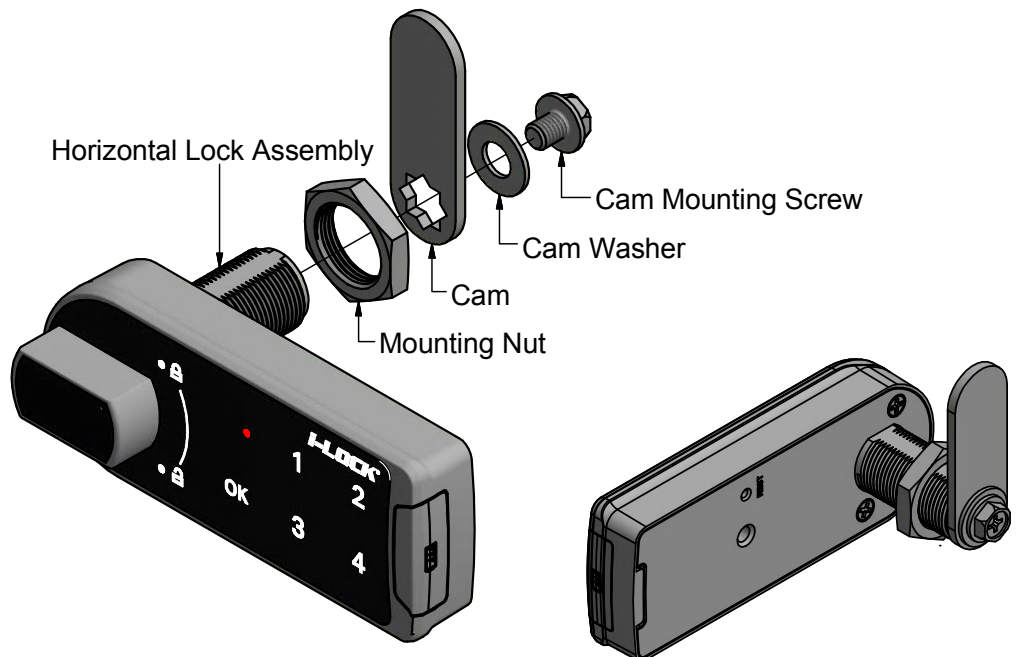

Illinois Lock Company
A division of the Eastern Company

www.illinoislock.com • sales@illinoislock.com • 847-537-1800



i-LOCK[®] Electronic Cam Lock

E901

Material and Finish

- Housing: Silver ABS Plastic

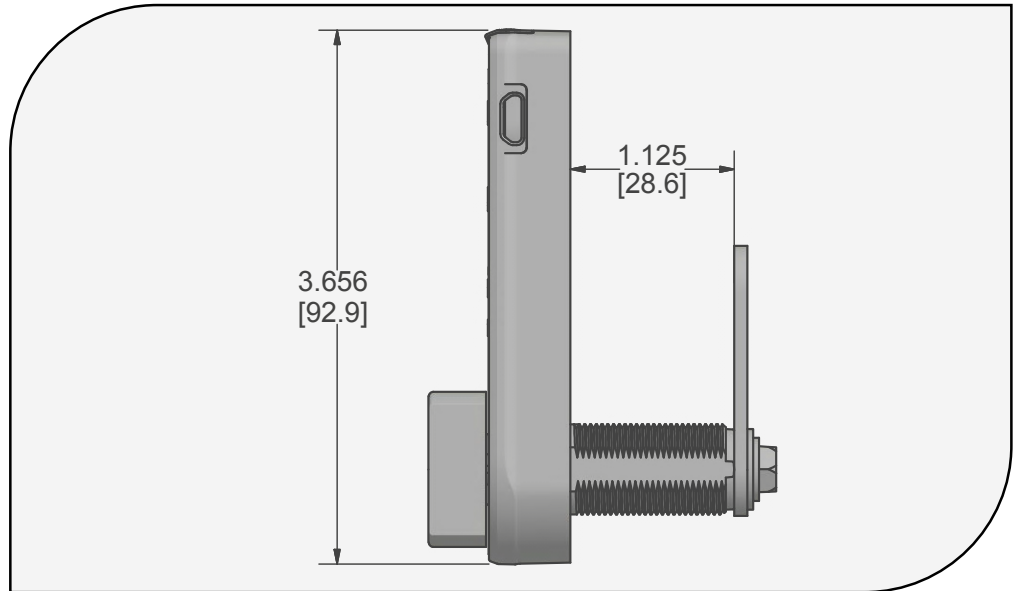

Vertical		
Part Number	Use	Color
E901VSS	Standard	Silver
E901VIS	One-Time	Silver

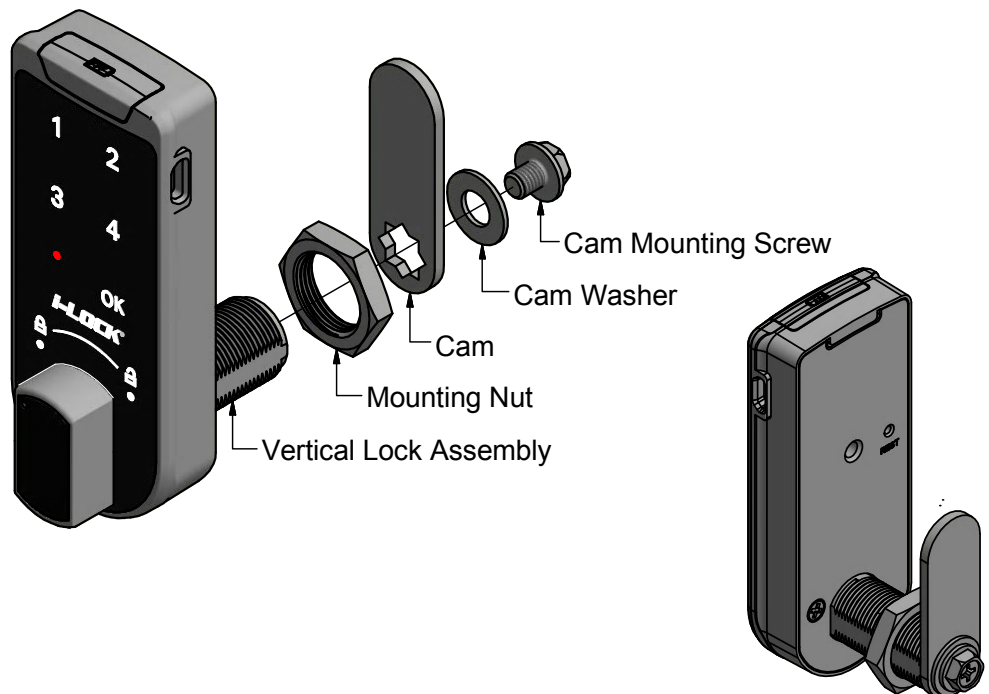

Illinois Lock Company
A division of the Eastern Company

www.illinoislock.com • sales@illinoislock.com • 847-537-1800



i-LOCK® Electronic Cam Lock E901

Lock Models, Rotations & Application Sizing

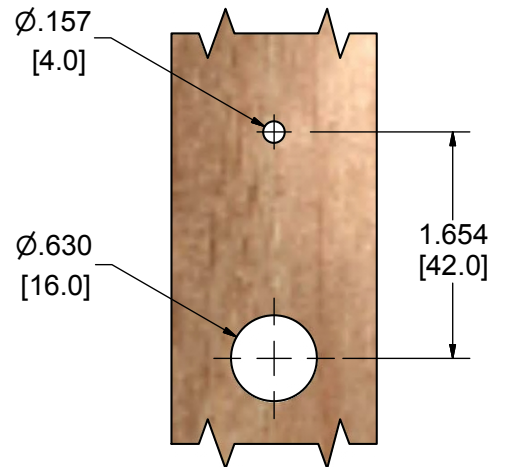
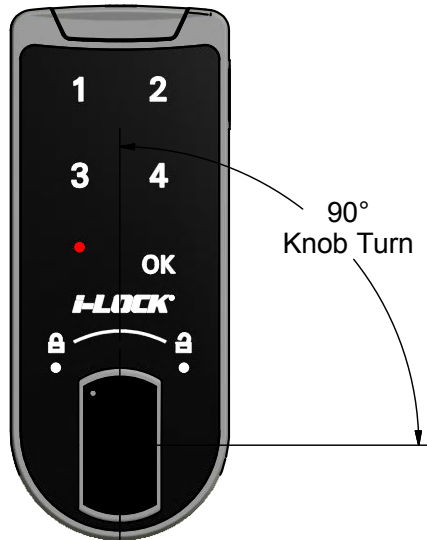
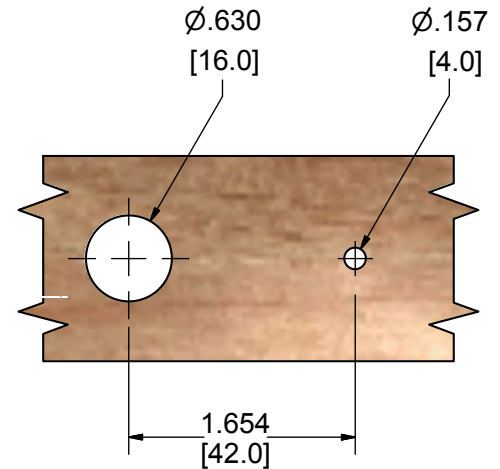
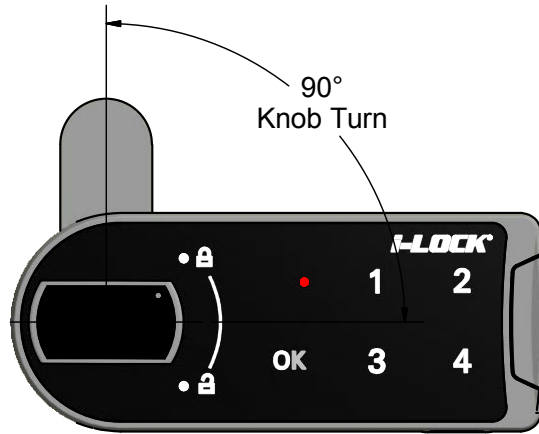



i-LOCK® Electronic Cam Lock

E901

Cam Types

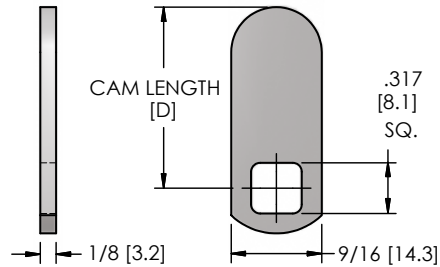

Straight Cams		
Part Number	Cam Length [D-Dim]	
	Inches	Millimeters
142F6280002G	5/8	15.9
026F1780002G	7/8	22.2
142F6380002G	1-1/8	28.6
168F4380002G	1-1/4	31.7
234F7280002G	1-17/32	38.9
119F8780002G	1-21/32	42.1

* length tolerance +/- .039" [1mm]

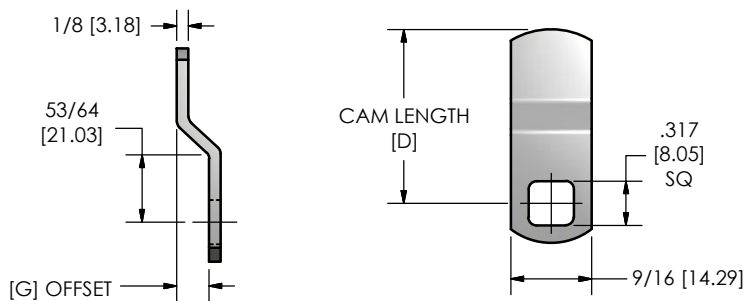

Offset Cams				
Part Number	Cam Length [D-Dim]		Offset Length [G-Dim]	
	Inches	Millimeters	Inches	Millimeters
026F1880002G	7/8	22.2	1/8	3.2
026F2080002G	7/8	22.2	1/4	6.4
026F1980002G	1-1/4	31.8	1/8	3.2
026F1780002G	1-1/4	31.8	1/4	6.4
234F7180002G	1-7/16	36.5	1/4	6.4

* length tolerance +/- .039" [1mm]

Illinois Lock Company
A division of the Eastern Company

www.illinoislock.com • sales@illinoislock.com • 847-537-1800



i-LOCK[®] Electronic Cam Lock

E901

Accessories/Replacement Parts



Cam Screw M5 X 6mm
PN: S9279



Short Installation Screw
PN: S9276



Long Installation Screw
PN: S9275



Barrel Nut M19
PN: D9868



Strike Plate Kit
PN: XS9278



i-LOCK[®] Electronic Cam Lock

E901

**All In-Stock Cam Locks
Supplied with following Hardware:**

- Lock Mounting Nut
- Cam Mounting Screw
- 1-1/4" straight cam
- Long Mounting Screw
- Short Mounting Screw
- Strike Plate Kit

In-Stock Cam Locks

Part Number	Use	Color
E901VSS	Standard	Silver
E901V1S	One-Time	Silver
E901RSS	Standard	Silver
E901R1S	One-Time	Silver

