

CONFIDENTIAL NOTICE: This drawing and the designs, specifications, and engineering information hereon are the property of Eberhard Manufacturing Company and are not to be disseminated or reproduced without express written consent. This drawing is loaned in confidence and then only for the consideration of the matter disclosed hereon. In accepting loan of this drawing, recipient agrees to keep it and the matter disclosed hereon in confidence and not to use or permit their use in any way detrimental to Eberhard Manufacturing Company, Division of The Eastern Company, 21944 Drake Road, Cleveland, Ohio, 44149-9712 © 2021 EBERHARD MFG. CO.

REVISION HISTORY					
REV	DESCRIPTION	EN	DATE	REV. BY	APVD BY
Initial Release		6082-A	12/15/2022	RPLIML	RPLIML

NOTES:
Blank Anodized Finish

Wiring: **NORMALLY OPEN ONLY**
Red - LED + (12VDC)
Black - LED - (12VDC)
Blue - NO
Blue - COMMON

LED Voltage: 12V
LED current: 20mA
Contact Voltage: 12V
Contact Current: 15A

Environment:
-30C - +80C / IP67

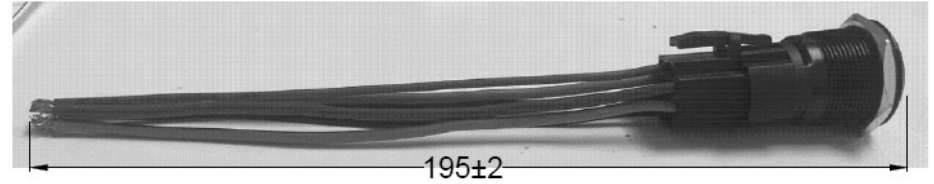
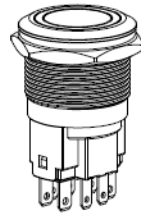
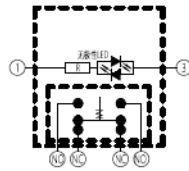
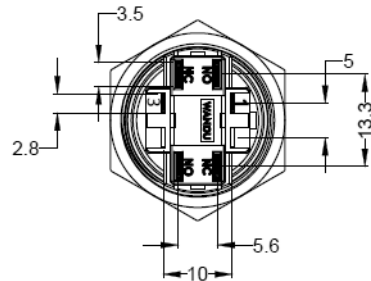
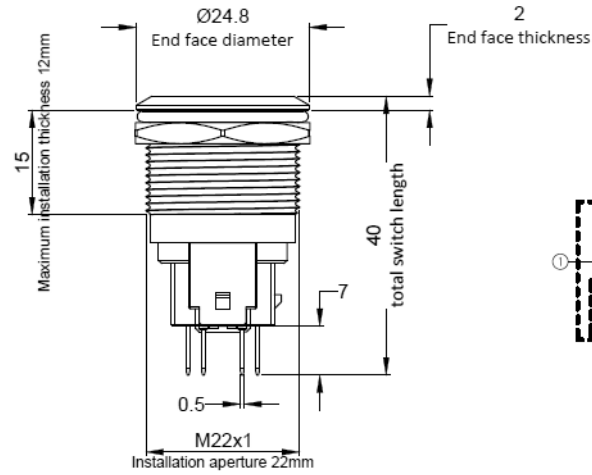
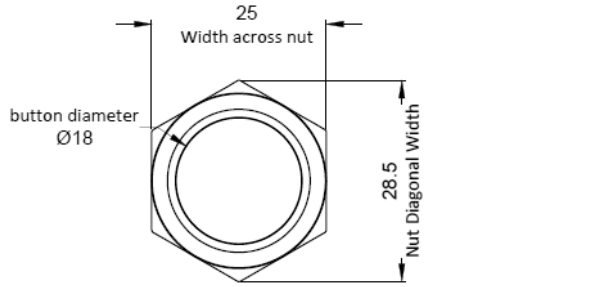

THIS DOCUMENT IS IN ACCORDANCE WITH ASME Y14.5-2009			DATE		NAME
LINEAR MEASUREMENT- INCH			12/15/2022		
UNLESS OTHERWISE SPECIFIED TOLERANCES ARE AS FOLLOWS:			DWN. BY		LED Push Button - 15A - White LED
ANGLES: ± 2° ± 2°			SCALE		
2 PLACE DEC.: ± .03 ± .76			MATERIAL		PART NUMBER
3 PLACE DEC.: ± .015 ± .38			CHK. BY		
ALL HOLES: ± .005 ± .13			EBX810-001-87		

CUSTOMER DRAWING

EBERHARD MANUFACTURING CO.

DIVISION OF
THE EASTERN COMPANY
CLEVELAND, OHIO 44149-9712