

CONFIDENTIAL NOTICE: This drawing and the designs, specifications, and engineering information hereon are the property of Eberhard Manufacturing Company and are not to be disseminated or reproduced without express written consent. This drawing is loaned in confidence and then only for the consideration of the matter disclosed hereon. In accepting loan of this drawing, recipient agrees to keep it and the matter disclosed hereon in confidence and not to use or permit their use in any way detrimental to Eberhard Manufacturing Company, Division of The Eastern Company, 21944 Drake Road, Cleveland, Ohio, 44149-9712 © 2021 EBERHARD MFG. CO.

REVISION HISTORY					
REV	DESCRIPTION	EN	DATE	REV. BY	APVD. BY
-	RELEASED	6009-C	7/2/21	RPLIML	
1	ADDED COLOR CODE FOR QUALITY ON INTERNAL USE PRINT	6035-H	1/28/2022	RPLIML	

NOTES:
 LED PUSH BUTTON WITH BLUE LED LIGHT
 22 MM DIAMETER

 IP65 RATING

 MOLEX CONNECTOR

 CABLE LENGTH: 1M

 PLUGS INTO BLUE ORIGIN INPUT PORT

 EBERHARD FINISHES AVAILABLE
 EBX800-016-66 - BRASS DIPPED CHROMATE
 EBX800-016-87 - BLACK ANODIZED ALUMINUM

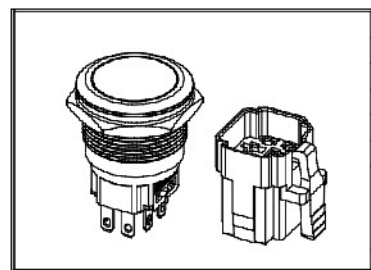
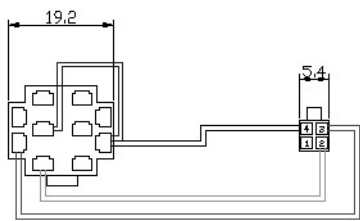
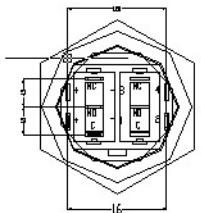
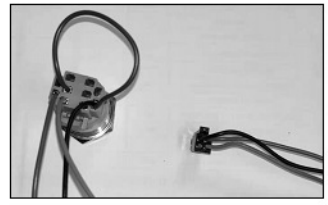
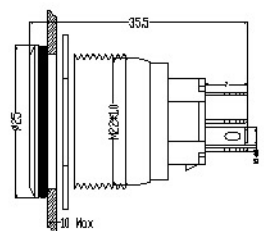
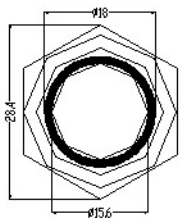

CUSTOMER PRINT

EBERHARD MANUFACTURING CO.
 DIVISION OF
 THE EASTERN COMPANY
 CLEVELAND, OHIO 44149-9712

THIS DOCUMENT IS IN ACCORDANCE WITH ASME Y14.5-2009		DATE		NAME	
LINEAR MEASUREMENT: INCH		6/24/2021		BLUE ORIGIN SWITCH, ILLUMINATED,	
UNLESS OTHERWISE SPECIFIED TOLERANCES ARE AS FOLLOWS:		DWN. BY		MOLEX	
		SCALE		MATERIAL	
		CHK. BY		PART NUMBER	
				EBX800-016	

ANGLES:	± 2°	± 2°
2 PLACE DEC.:	± .03	± .76
3 PLACE DEC.:	± .015	± .38
ALL HOLES:	± .005	± .13

C:\TEMP\lccd2d354-ab00-43d9-8638-771aacf5bec\EBX\EBX800-016.idw