

CONFIDENTIAL NOTICE: This drawing and the designs, specifications and engineering information disclosed hereon are the property of Eberhard Manufacturing Company and are not to be disseminated or reproduced without express written consent. The drawing is loaned in confidence and then only for consideration of the matter disclosed hereon. In accepting loan of this drawing, recipient agrees to keep it and the matter disclosed hereon in confidence and not to use nor permit their use in any way detrimental to Eberhard Manufacturing Company, Division of the Eastern Company, 21944 Drake Road, Cleveland, Ohio 44149-9712 © 2010 EBERHARD MFG. CO.

REVISION HISTORY			
REV	DESCRIPTION	EN	DATE
	RELEASED, REF 2-M10245-R/L	5503	5-13-2011
1	REVISED CALLOUT AND NOTE	5519	9/2/2011
2	REVISED FINISH TO (BG)	EN5667	8/17/2012

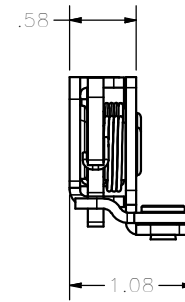
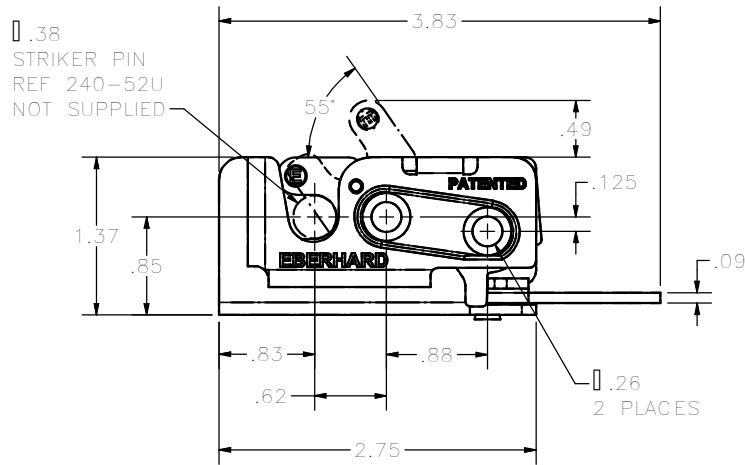
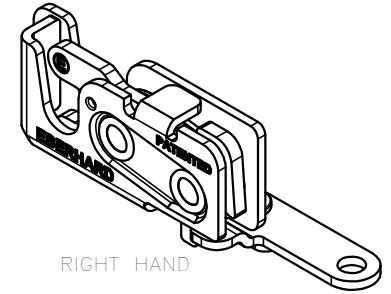
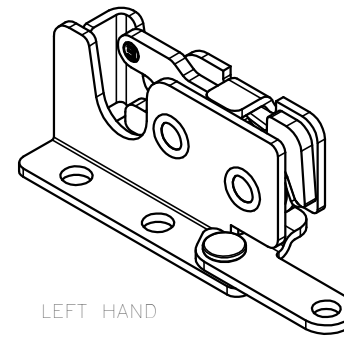
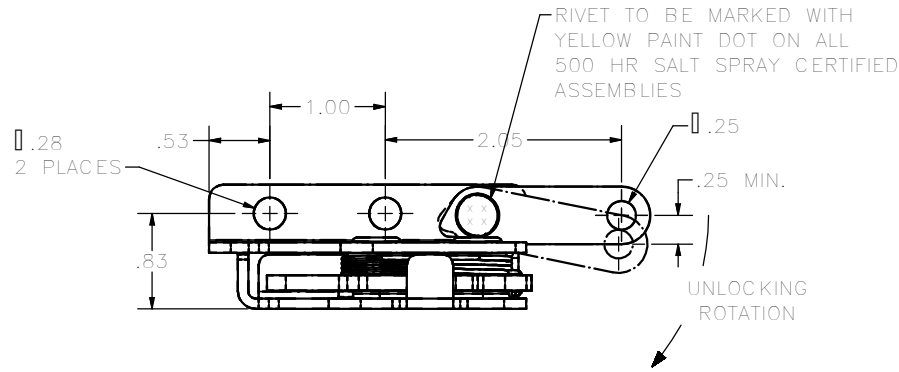

CUSTOMER PRINT
SHEET 1 OF 2
RIGHT HAND SHOWN
LEFT HAND OPPOSITE

NOTES:

- USE 1/4-20 GRADE 8 FASTENERS FOR INSTALLATION, RECOMMENDED TORQUE FOR TIGHTEN: 14 FT-LBS.
- FINISH: (BG) BEARING GREASE, E-COAT, FC (23) 500min HOURS FORD WSB-M64J28-A1/A2/A3/A4 CERTIFICATION REQUIRED.

UNLESS OTHERWISE SPECIFIED TOLERANCES ARE AS FOLLOWS:	
ANGLES:	∅ .0
2 PLACE DEC.:	∅ .03
3 PLACE DEC.:	∅ .015
ALL HOLES:	∅ .005

DATE: 5/10/2011	NAME: DOUBLE STAGE MINI-ROTARY LOCK ASSEMBLY
DESIGN BY: FLP	
SCALE: FULL	
CHECK BY:	PART NUMBER: 87-230-R/L

EBERHARD MANUFACTURING CO.
DIVISION OF
THE EASTERN COMPANY
CLEVELAND, OHIO 44149-9712