

CONFIDENTIAL NOTICE: This drawing and the designs, specifications and engineering information disclosed hereon are the property of Eberhard Manufacturing Company and are not to be disseminated or reproduced without express written consent. The drawing is loaned in confidence and then only for consideration of the matter disclosed hereon. In accepting loan of this drawing, recipient agrees to keep it and the matter disclosed hereon in confidence and not to use nor permit their use in any way whatsoever by Eberhard Manufacturing Company, Division of The Eastern Company, 2184 Drake Road, Cleveland, Ohio 44149-9712. © 2012 EBERHARD MFG. CO.

REVISION HISTORY			
REV	DESCRIPTION	EN	DATE
1	REVISED, REDRAWN AND CONVERTED TO 3D	5877	10-26-12

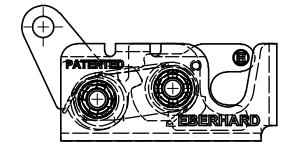

8-240-SSL
LEFT HAND
MINI-ROTARY LOCK

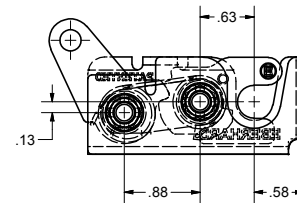
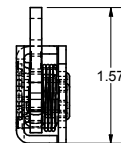
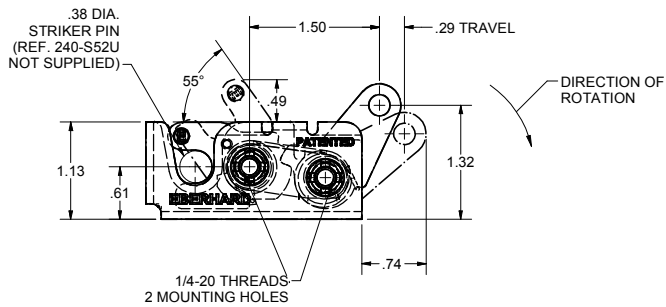
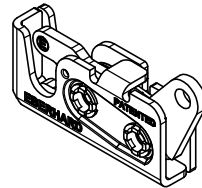
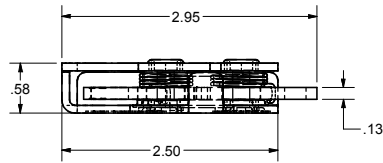

PATENTED
CUSTOMER PRINT
SHEET 1 OF 2
RIGHT HAND SHOWN
LEFT HAND OPPOSITE

WARNING
THIS PRODUCT MUST NOT BE USED FOR
PERSONAL RESTRAINT APPLICATIONS

MINI-ROTARY IS A TRADEMARK OF EBERHARD MFG. CO.,
DIVISION OF THE EASTERN COMPANY

- NOTES:
1. USE 1/4-20 GRADE 8 BOLTS FOR INSTALLATION
RECOMMENDED TORQUE FOR TIGHTENING: 14 FT.LBS.
2. MAX LOAD RATING: 750 LBS
3. FINISH: PASSIVATED QQ-P-35 TYPE 1, FC (22)

DATE	10/25/2012
DESIGNED BY	FLP
DRIVEN/TURNED/RETRACTED/RELEASED AND FOLLOWED	FULL
ANGLES:	0 0 0
2 PLACE DEC:	0.03 0.16
3 PLACE DEC:	0.015 0.38
4 PLACE DEC:	0.006 0.15

EBERHARD MANUFACTURING CO.	
DIVISION OF THE EASTERN COMPANY CLEVELAND, OHIO 44149-9712	
MINI-ROTARY LOCK	
DATE	10/25/2012
DESIGNED BY	FLP
DRIVEN/TURNED/RETRACTED/RELEASED AND FOLLOWED	FULL
ANGLES:	0 0 0
2 PLACE DEC:	0.03 0.16
3 PLACE DEC:	0.015 0.38
4 PLACE DEC:	0.006 0.15
DATE	10/25/2012
DESIGNED BY	FLP
DRIVEN/TURNED/RETRACTED/RELEASED AND FOLLOWED	FULL
ANGLES:	0 0 0
2 PLACE DEC:	0.03 0.16
3 PLACE DEC:	0.015 0.38
4 PLACE DEC:	0.006 0.15

SUPERSEDES DRAWING 8-240-SS RL SH1 DATED 8-19-96.

8-240-SS RL