

CONFIDENTIAL NOTICE: This drawing and the designs, specifications and engineering information disclosed hereon are the property of Eberhard Manufacturing Company and are not to be disseminated or reproduced without express written consent. The drawing is loaned in confidence and then only for consideration of the matter disclosed hereon. In accepting loan of this drawing, recipient agrees to keep it and the matter disclosed hereon in confidence and not to use nor permit their use in any way detrimental to Eberhard Manufacturing Company, Division of the Eastern Company, 21944 Drake Road, Cleveland, Ohio 44149-9712 © 2016 EBERHARD MFG. CO.

REVISION HISTORY				
REV	DESCRIPTION	EN	DATE	APVD BY
	RELEASED TO PRODUCTION/REF: 12290-B	S814	8/4/2017	KAB
				MR

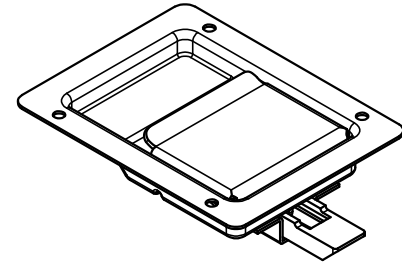

VIEW5  
SCALE 1 / 2

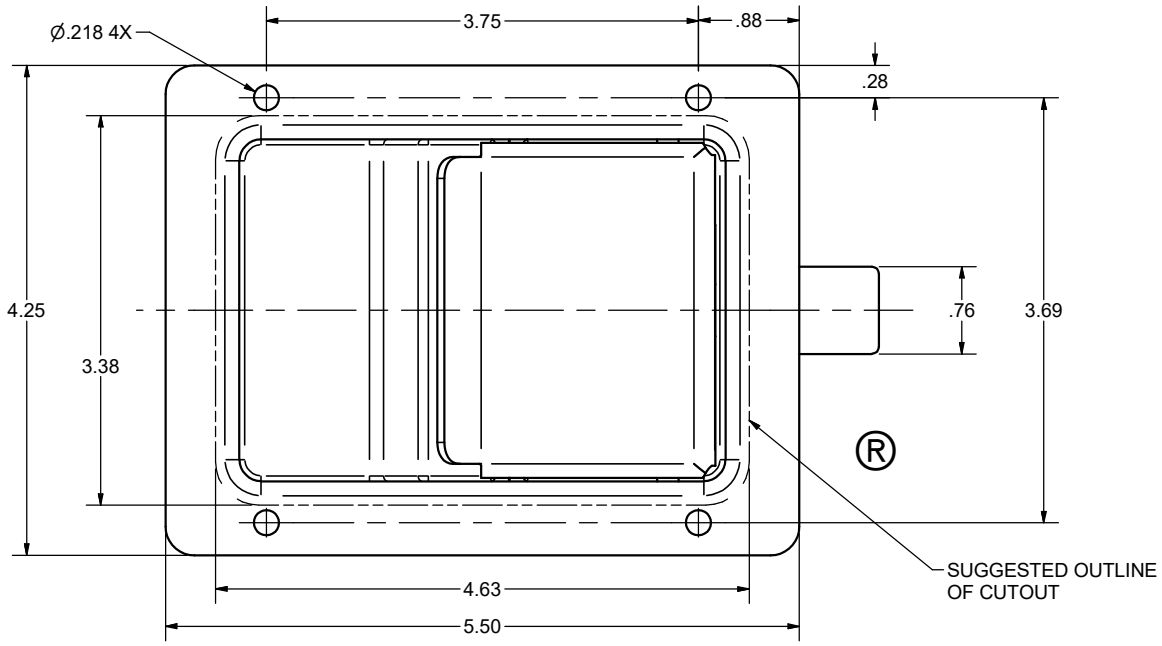
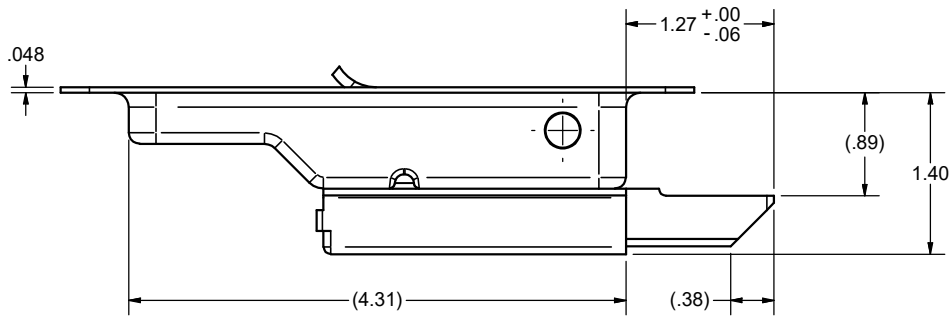

NOTE:  
1) FINISH: (10) BRIGHT STAINLESS STEEL.

NOTE: REGISTERED IN THE U.S. PATENT AND TRADEMARK OFFICE.

CUSTOMER PRINT  
SHEET 1 OF 2

**EBERHARD MANUFACTURING CO.**  
DIVISION OF  
**THE EASTERN COMPANY**  
CLEVELAND, OHIO 44149-9712

THIS DOCUMENT IS IN ACCORDANCE WITH ASME Y14.5-2009		DATE 8/4/2017
LINEAR MEASURE: INCH		DR. BY KAB
UNLESS OTHERWISE SPECIFIED TOLERANCES ARE AS FOLLOWS:		SCALE FULL
ANGLES:	± 2° ± 2°	CHK. BY
2 PLACE DEC.:	± .03 ± .76	
3 PLACE DEC.:	± .015 ± .38	
ALL HOLES:	± .005 ± .13	

NAME <b>UNIVERSAL (SLAM BOLT) PADDLE LOCK W/EXTENDED SLIDE BOLT</b>	
MATERIAL	PART NUMBER <b>76-4903-SS</b>

C:\TEMP\p157-42af-4d6c-b756-da800ef672e8\Pro\414902\_3\76-4903-SS SH1.dwt