

CONFIDENTIAL NOTICE: This drawing and the designs, specifications and engineering information disclosed hereon are the property of Eberhard Manufacturing Company and are not to be disseminated or reproduced without express written consent. The drawing is loaned in confidence and then only for consideration of the matter disclosed hereon. In accepting loan of this drawing, recipient agrees to keep it and the matter disclosed hereon in confidence and not to use nor permit their use in any way detrimental to Eberhard Manufacturing Company, Division of the Eastern Company. 21944 Drake Road, Cleveland, Ohio 44148-9712 © 2010 EBERHARD MFG. CO.

REVISION HISTORY					
REV	DESCRIPTION	EN	DATE	REV BY	APVD BY
	RELEASE, WAS 10-M8005-1R	5454	5/21/2010		
1	REMOVE VIEW, STRIKER DIA. .38 TO .375	5454	7/30/2010		
2	REMOVED LEFT HAND OPPOSITE NOTE	5542	2/24/2012		
3	ADDED CASE HEIGHT DIMENSION FOR REFERENCE	5596	3/22/2013		
4	ADD LEFT HAND VIEW & P/N	5809	6/30/2017	VRB	MR
5	ADDED: NOTE	5826	10/27/17	FLP	MR

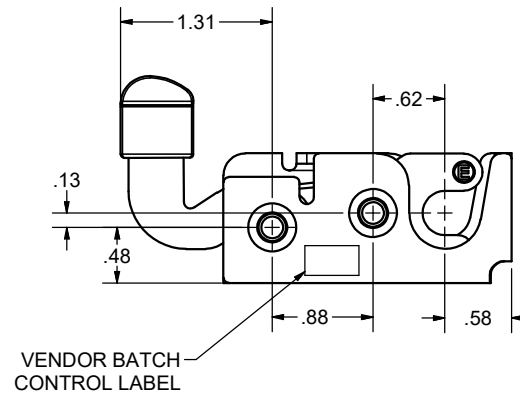
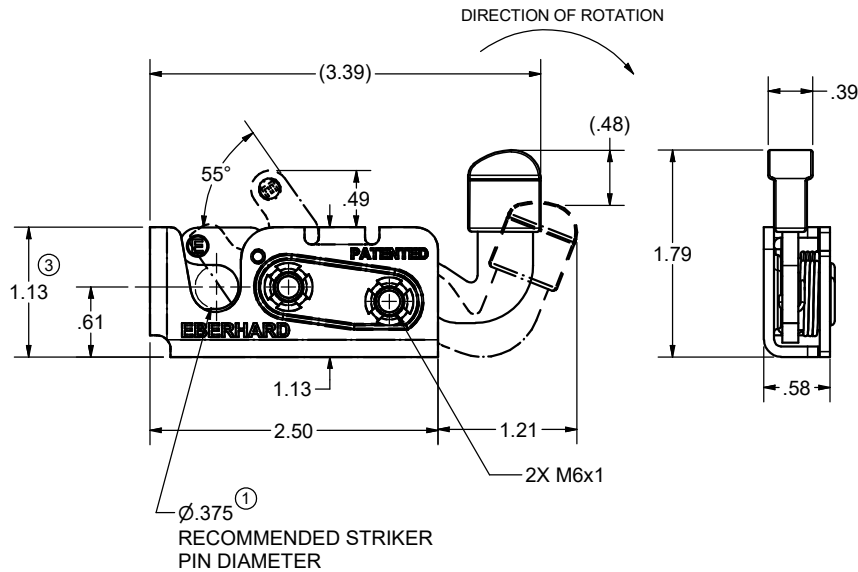
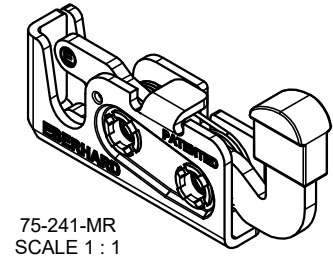
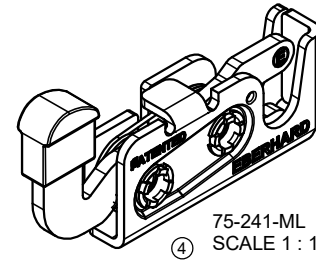

WARNING
THIS PRODUCT MUST NOT BE USED FOR PERSONAL RESTRAINT APPLICATIONS

MINI ROTARY IS A TRADEMARK OF EBERHARD MFG. CO., DIVISION OF THE EASTERN COMPANY.

CUSTOMER PRINT SHEET 1 OF 2
RIGHT HAND SHOWN (2)
LEFT HAND OPPOSITE

EBERHARD MANUFACTURING CO.
DIVISION OF
THE EASTERN COMPANY
CLEVELAND, OHIO 44148-9712

UNLESS OTHERWISE SPECIFIED TOLERANCES ARE AS FOLLOWS:		DATE	NAME
ANGLES:	± 2'	5/25/2010	SINGLE STAGE MINI-ROTARY LOCK ASSEMBLY WITH M6 MOUNTING THREADS
2 PLACE DEC.:	± .03	DR BY	
3 PLACE DEC.:	± .015	RBmot	
ALL HOLES:	± .005	SCALE	
		FULL	
		CHK BY	

MATERIAL	PART NUMBER
	75-241-MR/L (4)

- NOTES:
 1) USE M6X1 CLASS 8.8 BOLTS FOR INSTALLATION. RECOMMENDED INSTALLATION TORQUE: 14 FT-LB.
 2) MAX LOAD RATING - 750 LBS
 3) FOR ONE ASSEMBLY IN POLY BAG ORDER: 75-241-MR/LPK-BG.

FINISH: (64) ZINC & YELLOW CONVERTER WITH EVERLUBE INTERNAL COMPONENTS
 (BG) BEARING GREASE WITH EVERLUBE INTERNAL COMPONENTS