

CONFIDENTIAL NOTICE: This drawing and the designs, specifications and engineering information disclosed herein are the property of Eberhard Manufacturing Company and are not to be disseminated or reproduced without express written consent. The drawing is loaned in confidence and then only for consideration of the matter disclosed herein. In accepting loan of this drawing, recipient agrees to keep it and the matter disclosed herein in confidence and not to use nor permit their use in any way detrimental to Eberhard Manufacturing Company, Division of the Eastern Company, 21944 Drake Road, Cleveland, Ohio 44149-9712 © 2016 EBERHARD MFG. CO.

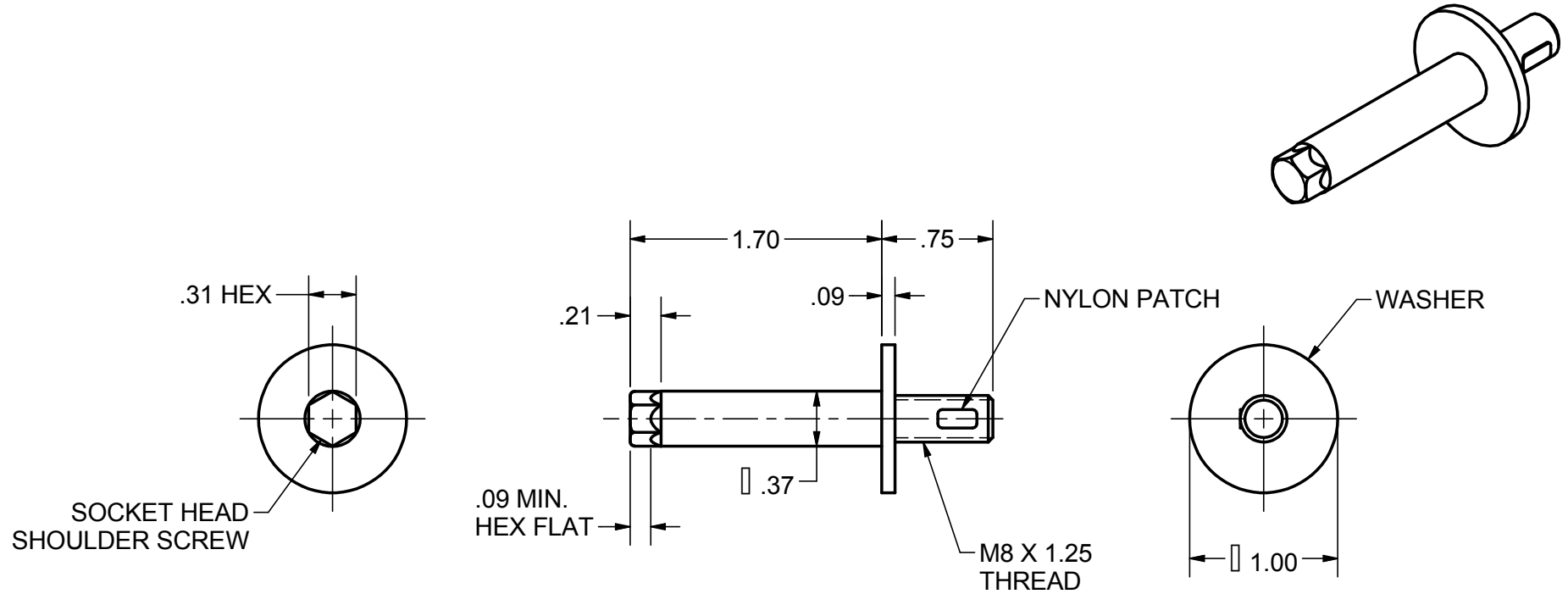

- NOTES:**
1. INSTALLATION: TORQUE TO 22 FT-LBS.
 2. FINISH: E-COAT, FC (23)
 3. REFERENCE: INTERNATIONAL TRUCK & ENGINE P/N: 3598944C3. ①



WARNING

THIS PRODUCT IS NOT CERTIFIED FOR
FMVSS 206 OR PERSONAL RESTRAINT APPLICATIONS

CUSTOMER PRINT
SHEET 1 OF 2

SUPERSEDES DRAWING 65-240-52M SHEET 1 OF 2 DATED 11-26-08.

LINEAR MEASURE: INCH						DATE 2/5/2016	EBERHARD MANUFACTURING CO. DIVISION OF THE EASTERN COMPANY CLEVELAND, OHIO 44149-9712	NAME STRIKER PIN WITH M8 THREAD AND WASHER SUB-ASSEMBLY		
UNLESS OTHERWISE SPECIFIED TOLERANCES ARE AS FOLLOWS:						DR. BY FLP		MATERIAL *		PART NUMBER 65-240-52M
ANGLES: IN MM						SCALE FULL		THIS DOCUMENT IS IN ACCORDANCE WITH ASME Y14.5-2009		
2 PLACE DEC.: .03 .76						CHK. BY				
3 PLACE DEC.: .015 .38										
ALL HOLES: .005 .13										
1	3598944C3 WAS 3598944C2	5741	2-26-16	FLP	MR					
REV	DESCRIPTION	EN	DATE	REV. BY	APVD. BY					

C:\Working_Folder\Archive\FASTENER\STRIKERS\65-240-52M SH1.idw