

CONFIDENTIAL NOTICE: This drawing and the design, specifications and engineering information contained herein are the property of Eberhard Manufacturing Company, and are not to be disseminated or reproduced without written consent. The drawing is issued for information and use only by the customer of the named product. In accordance with this drawing, no part shall be made, used, sold, transferred, or otherwise disposed of in any way without the written consent of Eberhard Manufacturing Company, a division of The Eastern Company, 2225 E. 12th Street, Cleveland, Ohio 44115-2225. © 2012 EBERHARD MFG. CO.

REVISION HISTORY					
REV	RELEASED	DESCRIPTION	EN	DATE	REV BY / APVD BY
1	RELEASED		5579	11/16/2012	
1	REVISED	BATCH CONTROL LABEL	5580	11/16/2012	
2	REVISED	VEWS	5646	3-21-14	
2	ADDED	GASKET PART # TO DWG PER ECR 342	6000	4/30/2011	DJK MR

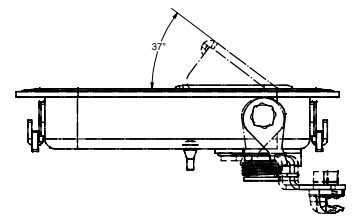
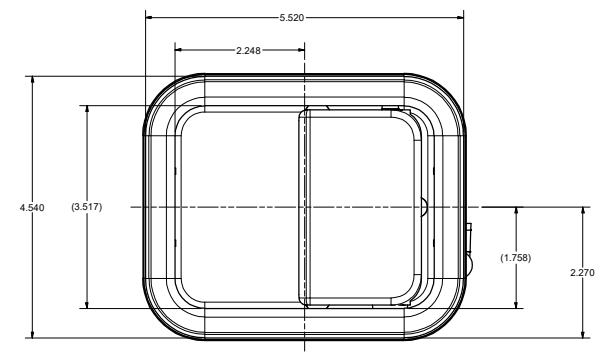
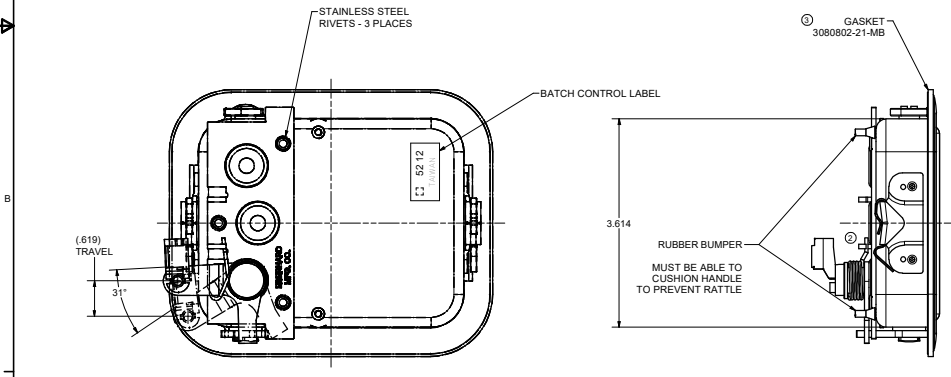
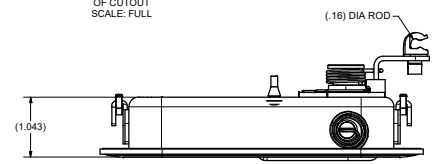
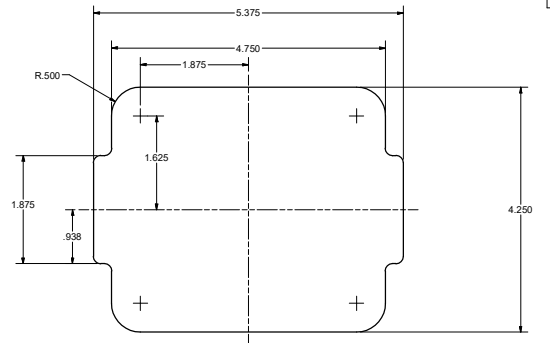
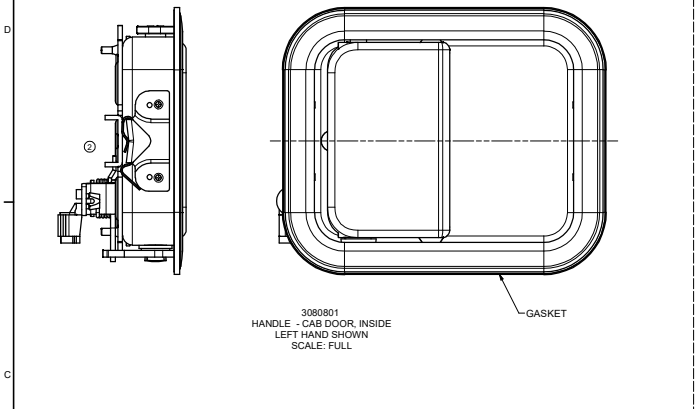

- NOTES:
 1) THIS PART COMPLIES WITH FMVSS 206 "DOOR LOCKS AND DOOR RETENTION COMPONENTS".
 2) HANDLE CASE TO BE .063" STEEL AND HANDLE TO BE .075" STEEL, (08) EXTERIOR BRIGHT POLISHED CHROME (SC4) PLATED WITH INSIDE OF CAVITY PAINTED WITHIN .25" OF THE FRONT FACE WITH METALIC GREY COLOR.
 3) * INDICATES GREASED AREAS. INCLUDES UPPER AND LOWER HANDLE PIVOTS TO PREVENT WATER LEAKS PAST THOSE POINTS.
 4) RETAINING WEDGE IS REFERENCE AND NOT PART OF THIS ASSEMBLY.

CUSTOMER PRINT
 SHEET 1 OF 2
 RIGHT HAND SHOWN
 LEFT HAND OPPOSITE

THIS DOCUMENT IS THE PROPERTY OF EBERHARD MFG. CO. IT IS TO BE USED ONLY FOR THE PURPOSES SPECIFIED HEREIN. IT IS NOT TO BE REPRODUCED OR TRANSMITTED IN ANY FORM OR BY ANY MEANS, ELECTRONIC OR MECHANICAL, INCLUDING PHOTOCOPYING, RECORDING, OR BY ANY INFORMATION STORAGE AND RETRIEVAL SYSTEM.		DATE	11/16/12
DESIGNED BY	REVISED BY	DATE	11/16/12
APPROVED BY	DATE	11/16/12	
ANGLES	UNLESS OTHERWISE SPECIFIED	ALL ANGLES	25°
SPRINGS	UNLESS OTHERWISE SPECIFIED	ALL SPRINGS	1.5
PLACES DEC.	UNLESS OTHERWISE SPECIFIED	ALL PLACES DEC.	1.5
SPRINGS DEC.	UNLESS OTHERWISE SPECIFIED	ALL SPRINGS DEC.	1.5
ALL HOLES	UNLESS OTHERWISE SPECIFIED	ALL HOLES	1.5

EBERHARD MANUFACTURING CO.
 DIVISION OF
 THE EASTERN COMPANY
 CLEVELAND, OHIO 44115-2225

HANDLE - CAB DOOR, OUTSIDE
 3080802

C:\Working_Folder\Ache\Final\3080802\3080802.CH 1811.dwg