

30589501

CONFIDENTIAL NOTICE: This drawing and the design, specifications and engineering information disclosed herein are the property of Eberhard Manufacturing Company and are not to be disseminated or reproduced without express written consent. The drawing is issued in confidence and is for consideration of the reader disclosed herein. In accepting hereof the drawing, recipient agrees to keep it and the matter disclosed herein in confidence and not to use nor permit their use in any way detrimental to Eberhard Manufacturing Company, Division of the Eastern Company, 21944 Dakota Road, Cleveland, Ohio 44138-6987 1800 EBERHARD MFG. CO. ©

NO.	CHANGE	ENG. NO.	DATE
1	RELEASED	EH 489	2-15-98

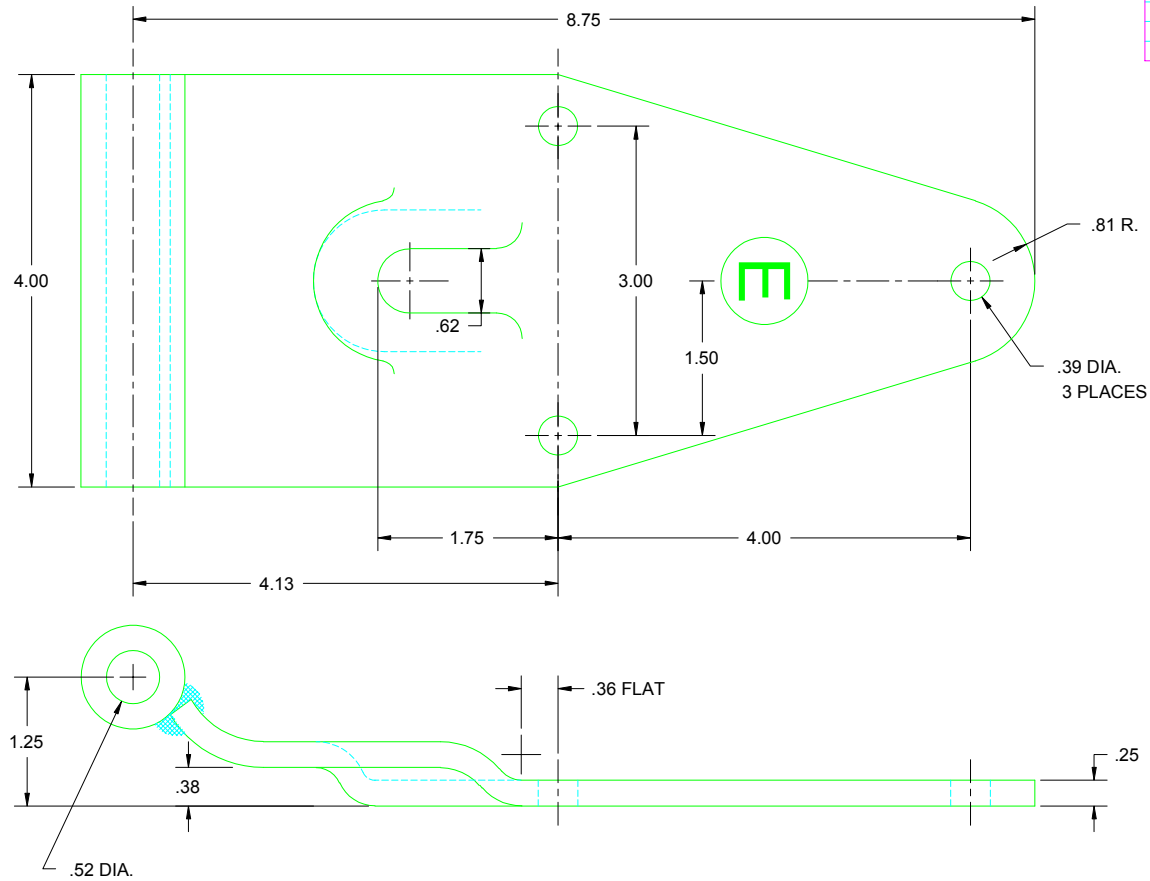

CUSTOMER PRINT
SHEET 1 OF 2

NOTE: FINISH - TCI POWDER COATINGS, #9900-9003
WHITE POLYESTER (FC PW) OR EQUIVALENT

UNLESS OTHERWISE SPECIFIED
TOLERANCES ARE AS FOLLOWS:

ANGLES: ±2°
2 PLACE DEC.: ±.03
3 PLACE DEC.: ±.015
ALL HOLES: ±.005

DATE: 2-12-98
DR BY: FLP
SCALE: FULL
CHK BY:

NAME:
MATERIAL:
PART NUMBER:

EBERHARD MANUFACTURING CO.
DIVISION OF
THE EASTERN COMPANY
CLEVELAND, OHIO 44138-6987

HINGE STRAP
SUB-ASSEMBLY

30-5897-50