

CONFIDENTIAL NOTICE: This drawing and the designs, specifications and engineering information disclosed hereon are the property of Eberhard Manufacturing Company and are not to be disseminated or reproduced without express written consent. The drawing is loaned in confidence and then only for consideration of the matter disclosed hereon. In accepting loan of this drawing, recipient agrees to keep it and the matter disclosed hereon in confidence and not to use nor permit their use in any way detrimental to Eberhard Manufacturing Company, Division of the Eastern Company, 23314 Drake Road, Cleveland, Ohio 44143-9312, © 2012 EBERHARD MFG. CO.

| REVISION HISTORY | | | |
|------------------|-----------------|------|---------|
| REV | DESCRIPTION | EN | DATE |
| 1 | CONVERTED TO .D | 3241 | 2/20/12 |

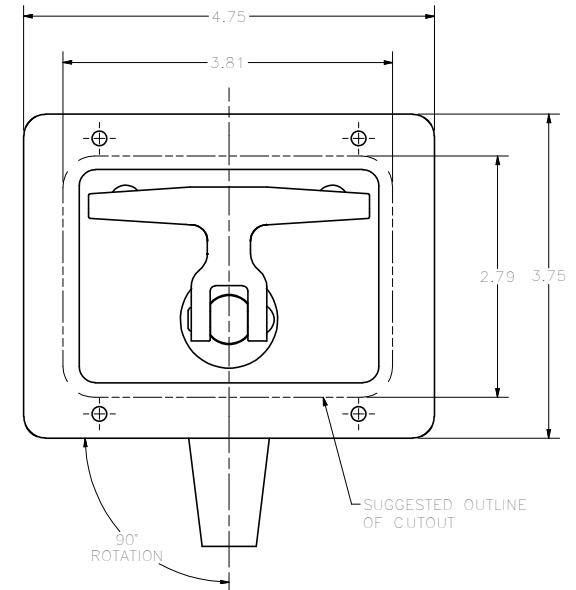
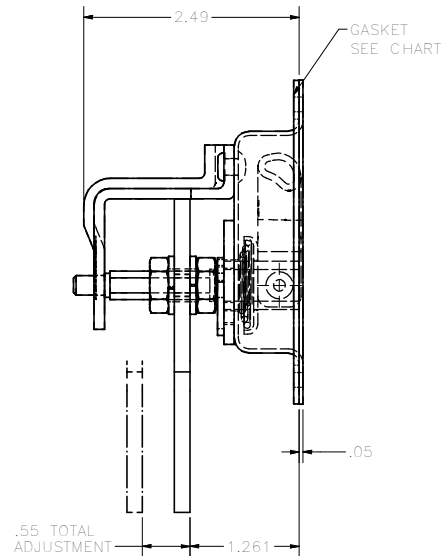
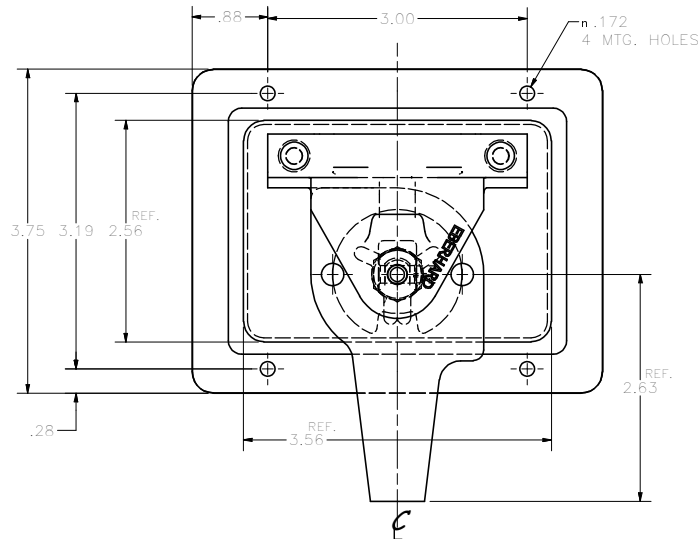

| PART No | GASKET THICKNESS |
|------------------|------------------|
| 2-8000-SSR/SSL | NO GASKET |
| 2-8000-SSRA/SSLA | .063 THICK |
| 2-8000-SSRB/SSLB | .031 THICK |

FINISH: BRIGHT POLISH STAINLESS STEEL, FC (10)

RIGHT HAND SHOWN
LEFT HAND OPPOSITE
CUSTOMER PRINT
SHEET 1 OF 2

SUPERSEDES DRAWING 2-8000-SSRLCH1 DATED 10-7-05.

| | | | |
|---|-------|---------------|----------|
| THIS DOCUMENT IS IN ACCORDANCE WITH ASME Y14.15-2009 | | DATE: 2/20/12 | |
| UNLESS OTHERWISE SPECIFIED DIMENSIONS ARE IN INCHES | | SCALE: FLP | UNIT: IN |
| ANGLES: ° ' " | ° ' " | SCALE: 1:1 | UNIT: IN |
| 2 PLACE DEC: +.03 +.06 | | | |
| 3 PLACE DEC: +.015 +.03 | | | |
| 4 PLACE DEC: +.005 +.01 | | | |

| | |
|--|-----------|
| EBERHARD MANUFACTURING CO. DIVISION OF THE EASTERN COMPANY CLEVELAND, OHIO 44143-9312 | |
| SINGLE POINT RECESSED FOLDING HANDLE WITH ADJUSTABLE LATCH | |
| PART NO: 2-8000-SSR/L | QUANTITY: |