

CONFIDENTIAL NOTICE: This drawing and the designs, specifications and engineering information disclosed hereon are the property of Eberhard Manufacturing Company and are not to be disseminated or reproduced without express written consent. The drawing is loaned in confidence and then only for consideration of the matter disclosed hereon. In accepting loan of this drawing, recipient agrees to keep it and the matter disclosed hereon in confidence and not to use nor permit their use in any way detrimental to Eberhard Manufacturing Company, Division of the Eastern Company, 21944 Drake Road, Cleveland, Ohio 44149-9712 © 2014 EBERHARD MFG. CO.

REVISION HISTORY			
REV	DESCRIPTION	EN	DATE
	CONVERTED TO 3D	5637	1-17-14
1	ADDED FINISHES	6010	7/8/2021

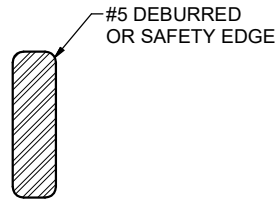
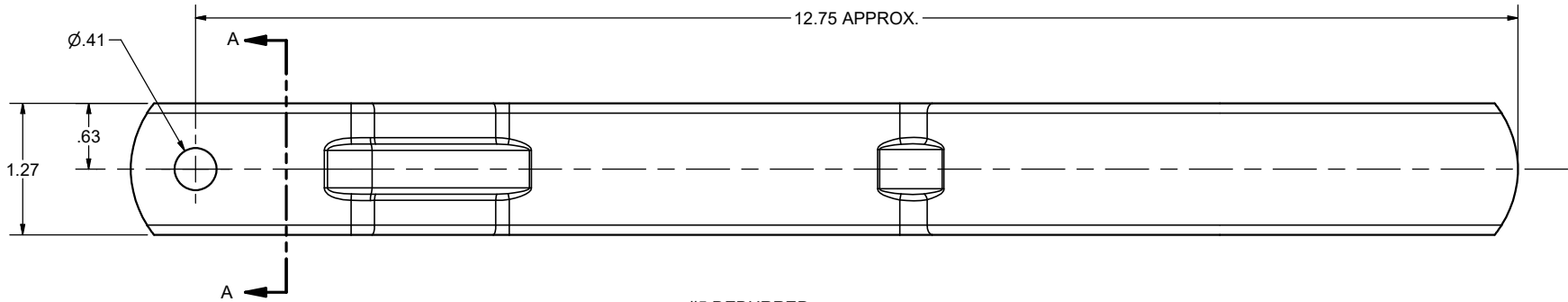
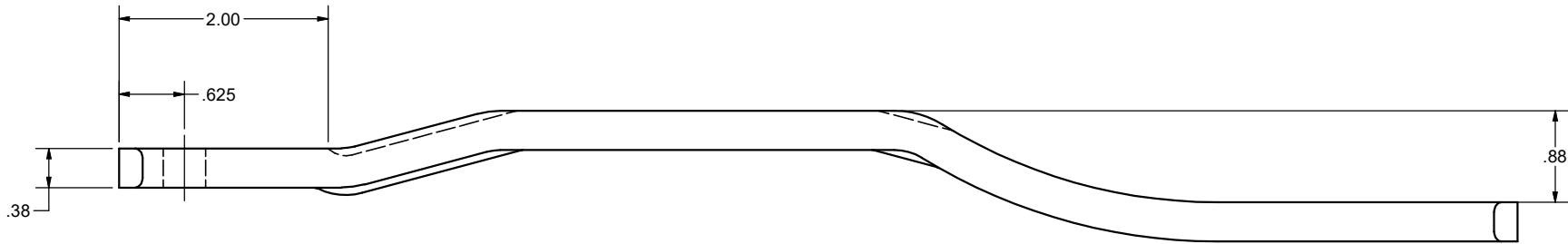

NOTE: FINISHES:
 1) - HOT DIP GALVANIZED, FC (13)
 - BLACK POWDER, FC (30)
 - YELLOW ZINC (65)
 - EBERGUARD II ZINC W/POLYMER (37)
CERTIFICATION REQUIRED ON FINISH.

SECTION A-A
 SCALE 1 : 1

SUPERSEDES DRAWING 1969-6X SHEET 1 OF 2 DATED 6-15-94.

CUSTOMER PRINT
 SHEET 1 OF 2

EBERHARD MANUFACTURING CO.
 DIVISION OF
 THE EASTERN COMPANY
 CLEVELAND, OHIO 44149-9712

THIS DOCUMENT IS IN ACCORDANCE WITH ASME Y14.15-2009		DATE 1/17/2014	NAME HANDLE															
UNLESS OTHERWISE SPECIFIED TOLERANCES ARE AS FOLLOWS:		DR BY FLP	SCALE FULL															
<table border="1"> <thead> <tr> <th></th> <th>IN</th> <th>MM</th> </tr> </thead> <tbody> <tr> <td>ANGLES:</td> <td>± 2'</td> <td>± 2'</td> </tr> <tr> <td>2 PLACE DEC.:</td> <td>± .03</td> <td>± .76</td> </tr> <tr> <td>3 PLACE DEC.:</td> <td>± .015</td> <td>± .38</td> </tr> <tr> <td>ALL HOLES:</td> <td>± .005</td> <td>± .13</td> </tr> </tbody> </table>			IN	MM	ANGLES:	± 2'	± 2'	2 PLACE DEC.:	± .03	± .76	3 PLACE DEC.:	± .015	± .38	ALL HOLES:	± .005	± .13	MATERIAL 3/8 X 1 1/4 MILL EDGE H.S.L.A. 45,000 MIN. YIELD	PART NUMBER 1969-6X
	IN	MM																
ANGLES:	± 2'	± 2'																
2 PLACE DEC.:	± .03	± .76																
3 PLACE DEC.:	± .015	± .38																
ALL HOLES:	± .005	± .13																