

CONFIDENTIAL NOTICE: This drawing and the designs, specifications and engineering information disclosed hereon are the property of Eberhard Manufacturing Company and are not to be disseminated or reproduced without express written consent. The drawing is loaned in confidence and then only for consideration of the matter disclosed hereon. In accepting loan of this drawing, recipient agrees to keep it and the matter disclosed hereon in confidence and not to use nor permit their use in any way detrimental to Eberhard Manufacturing Company, Division of the Eastern Company, 21944 Drake Road, Cleveland, Ohio 44149-9712 © 2012 EBERHARD MFG. CO.

REVISION HISTORY					
REV	DESCRIPTION	EN	DATE	REV BY	APVD BY
	REVISED, REDRAWN AND CONVERTED TO 3D	5581	11-30-12		
1	REVISED SUGGESTED CUTOUT	5873	10/5/2018	KAB	MR

P/N	DESCRIPTION	FINISH
172	RECESSED ROPE RING ASSEMBLY	(25) ELECTROPLATED ZINC
172-SS	S.S. RECESSED ROPE RING ASSEMBLY W/INVESTMENT CAST RING	(01) PLAIN

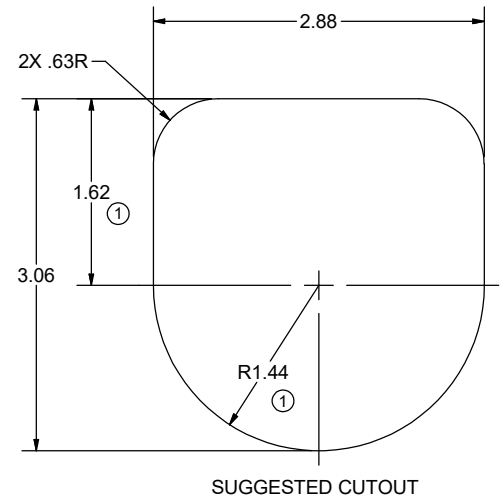
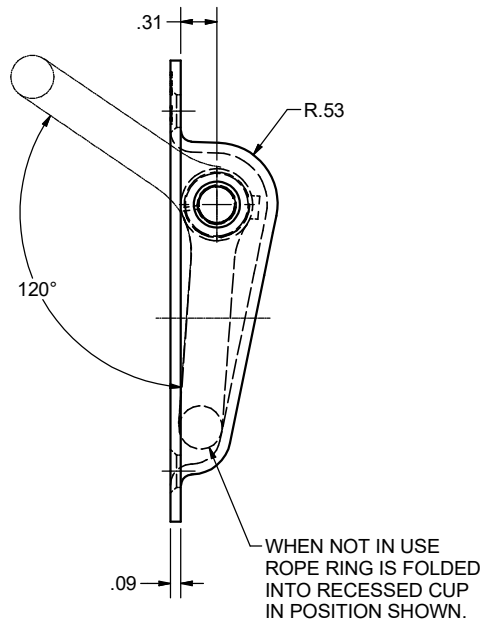
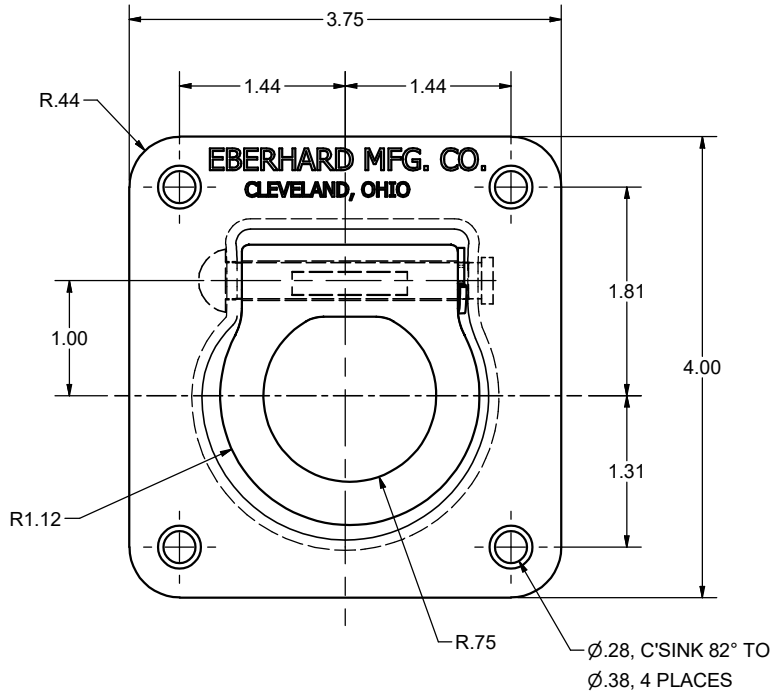
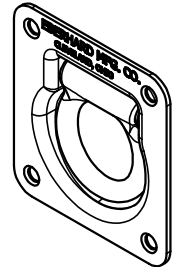

- NOTES:
 1. MAX. LOAD RATING= 2,000 LBS.
 2. WASHER MAY BE ADDED TO EITHER SIDE.

SUPERSEDES DRAWING 172 CHART SHEET 1 OF 2 DATED 6-17-93

THIS DOCUMENT IS IN ACCORDANCE WITH ASME Y14.5-2009	
LINEAR MEASURE: INCH	DATE: 11/30/2012
UNLESS OTHERWISE SPECIFIED TOLERANCES ARE AS FOLLOWS:	DR BY: FLP
IN MM	SCALE: FULL
ANGLES: ± 2° ± 2°	CHK BY:
2 PLACE DEC.: ± .03 ± .76	
3 PLACE DEC.: ± .015 ± .38	
ALL HOLES: ± .005 ± .13	

CUSTOMER PRINT SHEET 1 OF 2		
EBERHARD MANUFACTURING CO. DIVISION OF THE EASTERN COMPANY CLEVELAND, OHIO 44149-9712		
RECESSED ROPE RING ASSEMBLY		
MATERIAL: -----	PART NUMBER: 172 / SS	CHART: