

**CONFIDENTIAL NOTICE** This drawing and the design identification and engineering information disclosed herein are the property of Eberhard Manufacturing Company and are not to be disseminated or reproduced without express written consent. The drawing is issued in confidence and the only authorized recipient of the drawing is the customer. No part of this drawing, without express written consent of Eberhard Manufacturing Company, is to be used for any purpose other than that for which it was originally intended. Eberhard Manufacturing Company reserves the right to change this drawing without notice. © 2014 EBERHARD MFG. CO.

REVISION HISTORY			
REV.	DESCRIPTION	BY	DATE
1	RELEASED		

16906-L-DT  
LEFT HAND  
HEAVY DUTY ROTARY LOCK ASSEMBLY

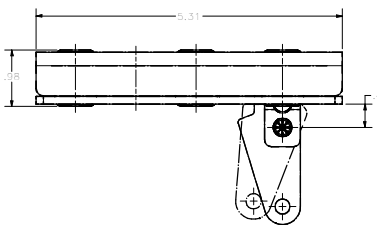
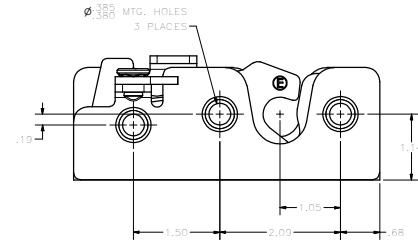
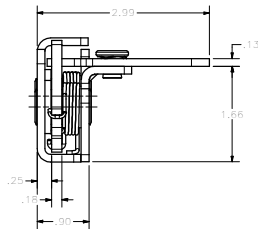
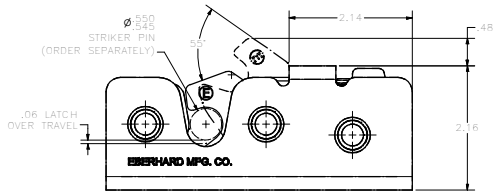
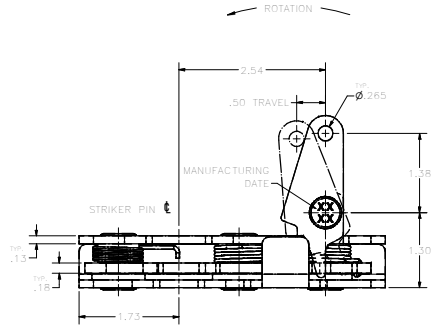

**NOTES:**

- THIS ROTARY LOCK ASSEMBLY MEETS ALL REQUIREMENTS FOR FMVSS 206 SAFETY STANDARD WHEN MOUNTED WITH THREE 3/8 HEX FLANGE SCREWS, GRADE 8.
- TORQUE TO 130 ±10 in.-lbs. WITH EBERHARD SUPPLIED STRIKER.
- MAX LOAD RATING:  

TRANSVERSE LATCHING POSITION:	LONGITUDINAL LATCHING POSITION:
PRIMARY LOAD: 4,000 lbs. MAX.	PRIMARY LOAD: 5,000 lbs. MAX.
SECONDARY LOAD: 3,000 lbs. MAX.	SECONDARY LOAD: 2,500 lbs. MAX.
- SPRING RATE:  
 STRIKE PLATE: 2.33 lbs.\*in. - UNLATCHED POSITION.  
 LATCH: 1.97 lbs.\*in. - UNLATCHED POSITION.  
 PAWL: 1.76 lbs.\*in. - ACTUATED POSITION.
- FINISH: (24) ELECTROPLATED ZINC.



CUSTOMER PRINT  
SHEET 1 OF 2  
RIGHT HAND SHOWN  
LEFT HAND OPPOSITE

**EBERHARD MANUFACTURING CO.**  
DIVISION OF  
THE EASTERN COMPANY  
10000 W. 11TH AVENUE, DENVER, CO 80202

DATE	DESCRIPTION	BY	DATE
16906-L-DT	HEAVY DUTY ROTARY LOCK ASSEMBLY		
ANGLED	4.75	SAK	
2 PLAC. DEC.	4.75	ENL	
3 PLAC. DEC.	4.75		
NO. Holes	4.75		
			16906-R/L

C:\TEMP\040428-1205-4228-0002-13a34838aef\Print\110000\16906\16906-16906-01.dwg