

CONFIDENTIAL NOTICE: This drawing and the designs, specifications and engineering information disclosed hereon are the property of Eberhard Manufacturing Company and are not to be disseminated or reproduced without express written consent. The drawing is loaned in confidence and then only for consideration of the matter disclosed hereon. In accepting loan of this drawing, recipient agrees to keep it and the matter disclosed hereon in confidence and not to use nor permit their use in any way detrimental to Eberhard Manufacturing Company, Division of the Eastern Company, 21944 Drake Road, Cleveland, Ohio 44149-9712 © 2013 EBERHARD MFG. CO.

REVISION HISTORY			
REV	DESCRIPTION	EN	DATE
1	CONVERTED TO 3D	5596	3-22-13

PART NO.	A	AVAILABLE FINISH	MATERIAL
16832-48	48.00	(64)	1010 STEEL
16832-36	36.00	(64)	1010 STEEL
16832-24	24.00	(64)	1010 STEEL
16832-12	12.00	(64)	1010 STEEL
16832-22	22.25	(64)	1010 STEEL

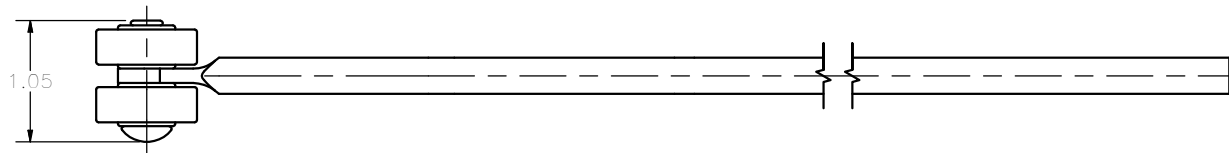
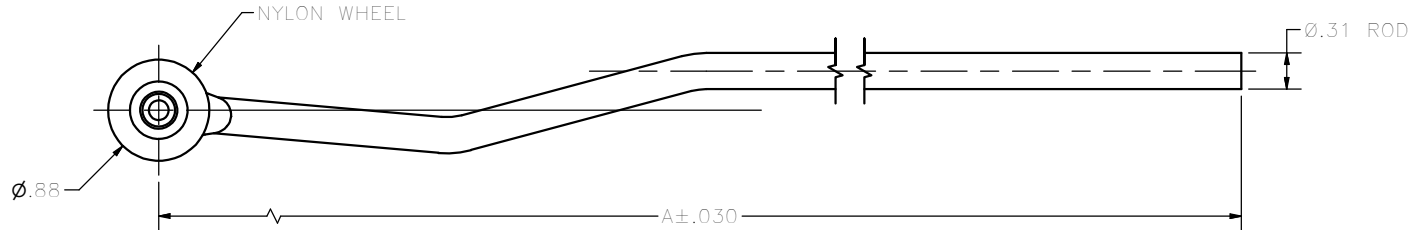

CUSTOMER PRINT
SHEET 1 OF 2

EBERHARD MANUFACTURING CO.
DIVISION OF
THE EASTERN COMPANY
CLEVELAND, OHIO 44149-9712

THIS DOCUMENT IS IN ACCORDANCE WITH		DATE
ASME Y14.15-2009		3/22/2013
UNLESS OTHERWISE SPECIFIED TOLERANCES ARE AS FOLLOWS:		DR BY
	IN	FLP
	MM	SCALE
ANGLES:	± 2°	± 2°
2 PLACE DEC.:	± 0.3	± 76
3 PLACE DEC.:	± 0.15	± 3R
ALL HOLES:	± 0.015	± 12
	CHK. BY	

NAME
LOCK ROD WITH ROLLERS

MATERIAL
SEE CHART

PART NUMBER
16832-48

CHART

SUPERSEDES DRAWING 16832-48 CHART SHEET 1 OF 2 DATED 8-19-03.

C:\TEMP\38786e92-at13f-4e93-bdde-67c463f9c2\FASTENER\ROD\ROLLERS ON END\16832-48 CH SH1.idw