



EBERHARD®



PADLOCKS *PRODUCT CATALOG 2019*

OUR FEATURED BRANDS **Sesamee®** **CCL**
Security Products

EBERHARD MANUFACTURING

Established in 1877, The Eberhard Manufacturing Company is a global leader in the engineering and manufacturing of access & security hardware. We have a standard product line of rotary latches, compression latches, draw latches, hinges, cam locks, key switches, padlocks, and handles to name a few. We also offer full development and program management services for custom electromechanical and mechanical systems designed for specific OEM's and customer applications. Our products are found in an expansive range of applications and products globally, virtually unnoticed in our everyday lives. Typically, you are never more than 6 feet from one of our solutions.

The Eberhard Manufacturing Company is a registered ISO9001:2015 and ISO14001:2015 company based in Strongsville, Ohio. Our core manufacturing capabilities are in die-casting, injection molding, stamping, machining and final assembly. Our passion for engineering drives us forward. Developing new products to meet our customer's design challenges is our main objective. Adding haptics and functionality to our products ultimately supports our customer's brand equity and increases the value of their end products.

Eberhard is a division of The Eastern Company (Nasdaq stock ticker EML).

LOCATIONS

USA

Corporate/Manufacturing

Eberhard Manufacturing Company
21944 Drake Road
Strongsville, OH 44149-9712

Sales & Engineering

Eberhard Manufacturing Company
3930 N Ventura Drive
Arlington Heights, IL 60004

CHINA

Manufacturing

Eberhard – Dongguan
Building 13, No. 199 Pulong Road, Tangxia Town
Shenzhen Shi Guangdong Sheng Dongguan City,
Guangdong Province 523719, China

Manufacturing

Eberhard – Eastern Industrial, Ltd. (Shanghai)
20 Lane 2248 Liuxiang Road
Shanghai, China 201801

MEXICO

Manufacturing

Eberhard – Reynosa
Villas del Parque, 88780 Reynosa,
Tamaulipas, Mexico

436 | 437 SERIES COMBINATION PADLOCKS

4 - DIAL RESETTABLE BRASS BODY with BRASS INTERNAL MECHANISM

PART #	SHACKLE CLEARANCE (A)	FINISH	PACKAGING	SHELF PACK	MASTER CARTON
436	1"	Brass	Boxed	6	36
K436	1"	Brass	Visual	6	36
K0436	1"	Brass	Visual	5	50
KCR0436	1"	Chrome	Visual	5	50
437	2.25"	Brass	Boxed	6	36
K437	2.25"	Brass	Visual	6	36
K0437	2.25"	Brass	Visual	5	50
K440	4"	Brass	Visual	5	50

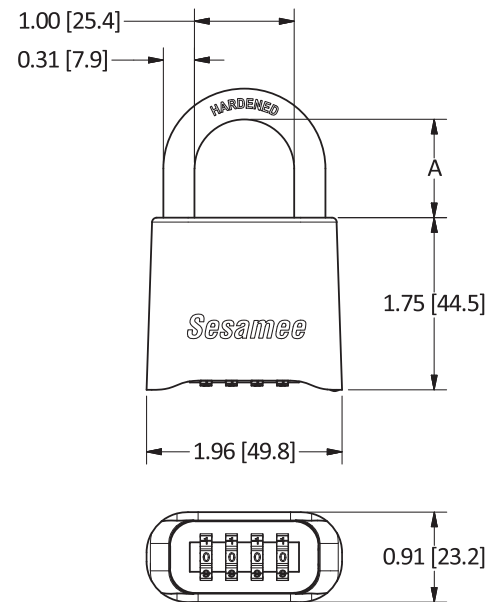

BEST USED FOR: INDUSTRIAL | COMMERCIAL

Job boxes & gang boxes | Utility meters, substations & cable boxes
Tool chests, boxes & cribs | Lockers

- Convenient, easy-to-set and reset combination
- 10,000 possible combinations
- All-brass internal locking mechanism, including dials
- Tough heel and toe lever locking system
- Hardened steel, chrome-plated shackle
- Automatic "0000" stop
- Resetting tool included

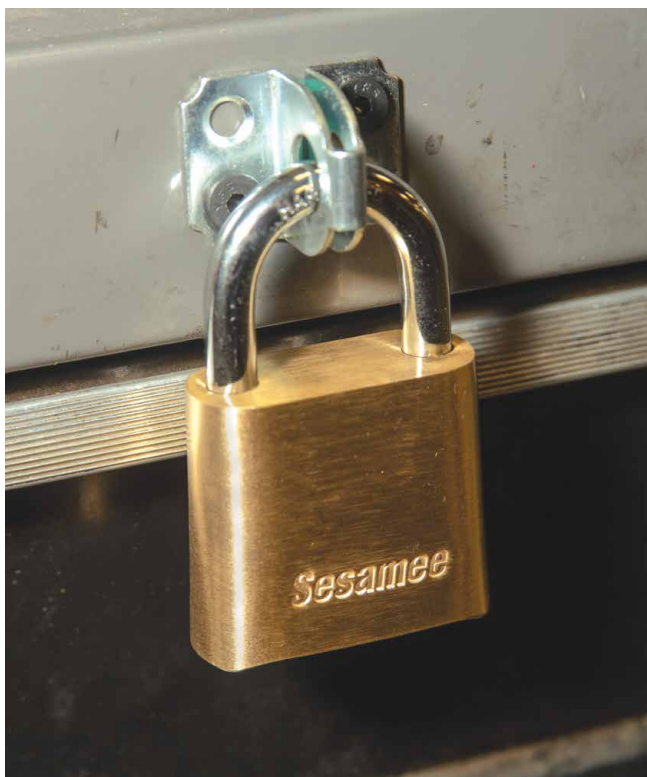

436
K436



437
K437

K440

K0437

K0436

KCR0436

436
K436



437
K437

500 SERIES COMBINATION PADLOCKS

4 - DIAL RESETTABLE DIECAST with BRASS INTERNAL MECHANISM

PART #	SHACKLE CLEARANCE (A)	FINISH	PACKAGING	SHELF PACK	MASTER CARTON
K5003/4	1"	Black	Visual	5	50
K5002-1/4	2.25"	Black	Visual	5	50

BEST USED FOR: INDUSTRIAL | COMMERCIAL

Job boxes & gang boxes | Utility meters, substations & cable boxes

Tool chests, boxes & cribs | Lockers

- Convenient, easy-to-set and reset combination
- 10,000 possible combinations
- Hardened steel, chrome-plated shackle
- Tough heel and toe lever locking system
- Automatic "0000" stop
- Black epoxy finish
- Resetting tool included



K5002-1/4



K5003/4

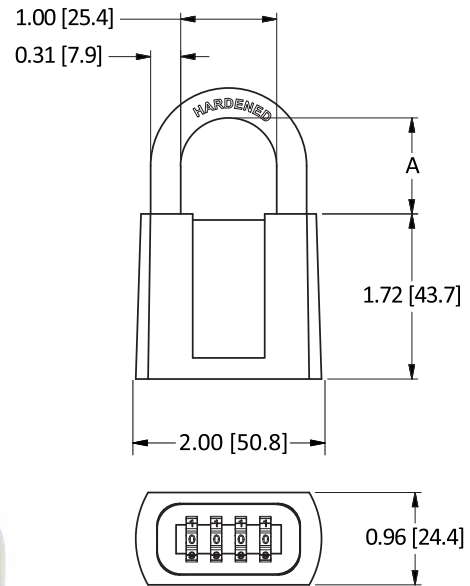

436L | 437L SERIES COMBINATION PADLOCKS

RESETTABLE STEEL LAMINATED BODY PADLOCK

PART #	SHACKLE CLEARANCE (A)	FINISH	PACKAGING	SHELF PACK	MASTER CARTON
436L	1"	Zinc-plated	Boxed	6	36
437L	2.25"	Zinc-plated	Boxed	6	36

BEST USED FOR: INDUSTRIAL | COMMERCIAL

Job boxes & gang boxes | Utility meters, substations & cable boxes

Tool chests, boxes & cribs | Lockers

- Convenient, easy-to-set and reset combination
- 10,000 possible combinations
- Laminated steel body
- Hardened steel, chrome-plated shackle
- Tough heel and toe lever locking system
- Resetting tool included



436L

437L

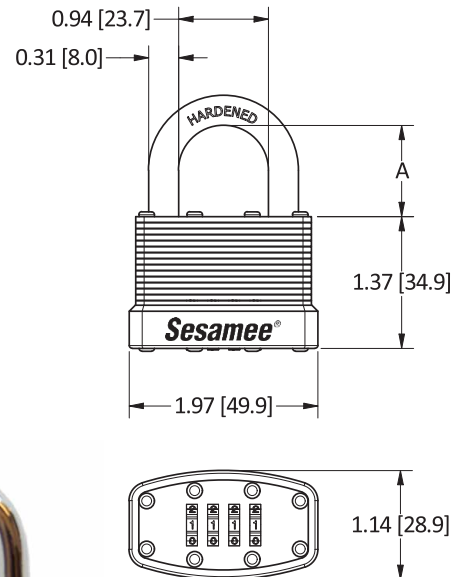

906 SERIES PADLOCKS

PIN TUMBLER SOLID BRASS with HARDENED STEEL, CHROME-PLATED SHACKLE

PART #	KEYED	SHACKLE CLEARANCE	FINISH	SHELF PACK	MASTER CARTON
00140	KA2A36485	.81"	Brass	25	100

BEST USED FOR: RESIDENTIAL | RETAIL

Cash Boxes | Lockers | Cupboards | Jewel Boxes | Bags & Suitcases

- Standard keyway: AR, others available
- 5 pin tumblers
- Master keying available
- Tough, durable security
- Weather-resistant

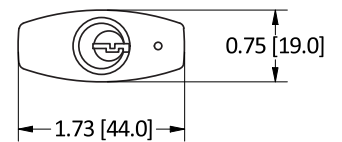
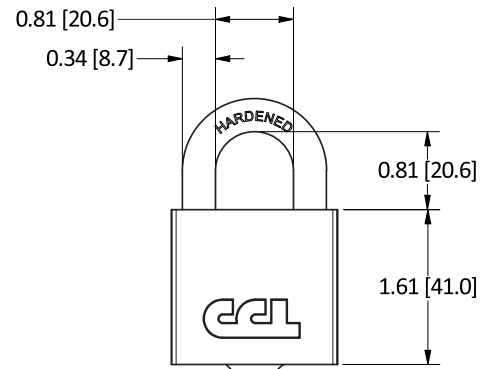

95 SERIES KEYED PADLOCKS

PIN TUMBLER DIECAST with HARDENED STEEL, CHROME-PLATED SHACKLE

PART #	KEYED	SHACKLE CLEARANCE	FINISH	PACKAGING	SHELF PACK	MASTER CARTON
P95505	KA12B130	.77"	Dull Chrome	Boxed	10	80

BEST USED FOR: INDUSTRIAL | COMMERCIAL

Job boxes & gang boxes | Utility meters, substations & cable boxes
Tool chests, boxes & cribs | Lockers

- 2 keys blank no. 8687C-CR
- CR keyway
- Tough heel and toe lever locking system

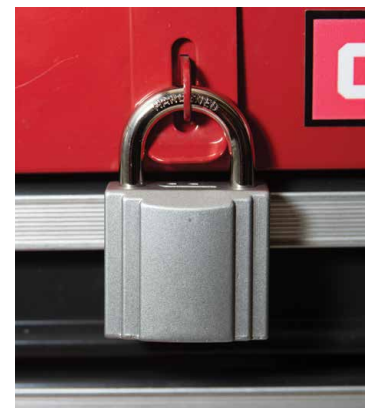
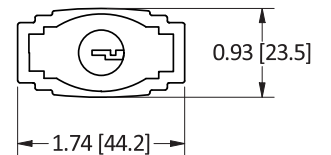
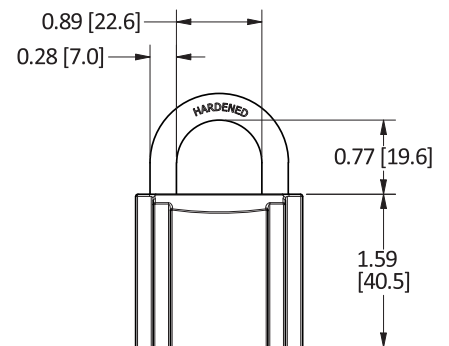

66 SERIES PADLOCKS

DISC TUMBLER REKEYABLE DIECAST BODY with HARDENED STEEL, CHROME-PLATED SHACKLE

PART #	KEYED	SHACKLE CLEARANCE (A)	FINISH	SHELF PACK	MASTER CARTON
00090	KA AUE 1	.75"	Powder Coat	10	80
00091	KA CAT 15	.75"	Powder Coat	10	80
00092	KA CAT 30	.75"	Powder Coat	10	80
00094	KA CAT 60	.75"	Powder Coat	10	80
00096	KD AUE	2.75"	Powder Coat	10	80
00097	KA AUE 1	2.75"	Powder Coat	10	80
00098	KD & MK M8003	2.75"	Powder Coat	10	80
00099	KD AUE	5"	Powder Coat	10	80

BEST USED FOR: INDUSTRIAL | COMMERCIAL

Job boxes & gang boxes | Utility meters, substations & cable boxes | Tool chests, boxes & cribs | Lockers

- Solid pressure cast, textured military green matte finish. Hardened steel, chrome-plated shackle.
- Key blank no.: 5865-JVR (5 Disc), 8658-JVR (6 Disc)
- Regular key changes: 200 (5 Disc), 700 (6 Disc)
- Master keying available
- Chain: available with 2217N steel chain assembly, 9" [22.86cm] chain. Specify on order suffix "C" (e.g., 66C)

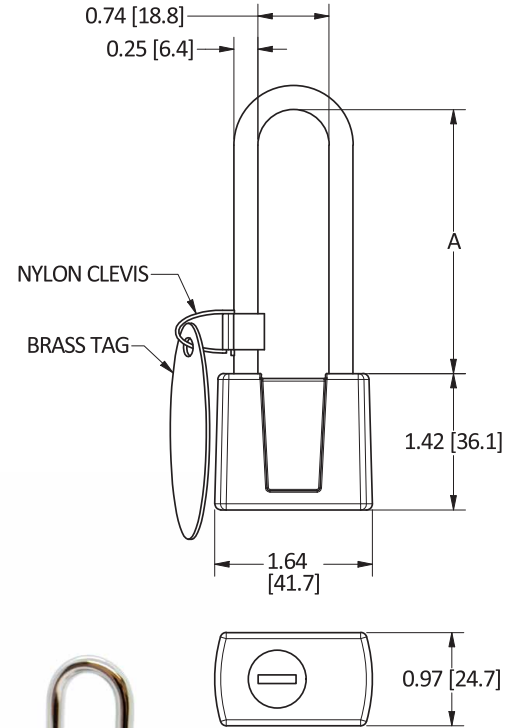

00096
00097
00098

760 SERIES SFIC KEYED PADLOCKS

INTERCHANGEABLE CORE PADLOCK

PART #	KEYED	SHACKLE CLEARANCE (A)	FINISH	SHELF PACK	MASTER CARTON
76012	SFIC	1.5"	Brass	6	30

BEST USED FOR: INDUSTRIAL | COMMERCIAL

Job boxes & gang boxes | Utility meters, substations & cable boxes | Tool chests, boxes & cribs | Lockers

- Brass body padlock without SFIC core
- Works with most SFIC cylinders
- Non-key retaining
- Quality solid brass and stainless steel construction
- Dual ball-bearing locking mechanism
- Hardened steel, chrome-plated molybdenum shackle

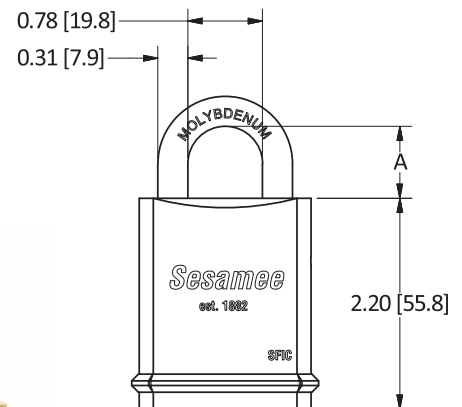

76012

165 SERIES COMBINATION PADLOCKS

TRADITIONAL DURABLE LOCK

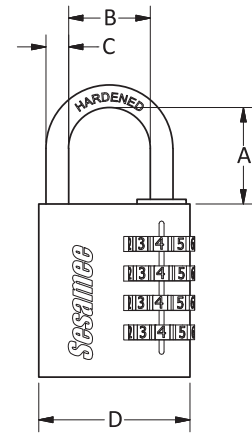

PART #	SHACKLE CLEARANCE	FINISH	PACKAGING	SHELF PACK	MASTER CARTON
16520	.85"	Brass	Boxed	12	144
16530	1"	Brass	Boxed	12	144
16540	1"	Brass	Boxed	6	36

PART #	(A)	(B)	(C)	(D)	# of DIALS
16520	.85" [21.6mm]	.35" [9mm]	.13" [3.2mm]	.75" [20mm]	3
16530	.94" [24mm]	.56" [14.3mm]	.19" [4.8mm]	.81" [30mm]	3
16540	.98" [25mm]	.85" [21.6mm]	.24" [6mm]	1.56" [40mm]	4

BEST USED FOR: RESIDENTIAL | RETAIL

Cash Boxes | Lockers | Cupboards | Jewel Boxes | Bags & Suitcases

- Chrome-plated shackle
- Keyless convenience
- Convenient, easy-to-set combination



16540 (back)
16530
16520 (front)



16530

16540

16520

936 | 937 SERIES HARDENED PADLOCKS

HEAVY-DUTY ROUND BODY PADLOCK

PART #	KEYED	SHACKLE CLEARANCE	PACKAGING	SHELF PACK	MASTER CARTON
93601	KA/62573	1"	Boxed	6	24
93602	KD	1"	Boxed	6	24
93610	KIK	1.125"	Boxed	6	24
93701	KA/62573	2"	Boxed	6	24
93702	KD	2"	Boxed	6	24
93710	KIK	2.125"	Boxed	6	24

BEST USED FOR: INDUSTRIAL | COMMERCIAL

Job boxes & gang boxes | Utility meters, substations & cable boxes
Tool chests, boxes & cribs | Lockers

- Keyed 936/937 in the popular American® AM3 Keyway
- Molybdenum alloy shackle
- Round solid steel body, chrome finish
- Dual ball-bearing locking mechanism
- Rekeyable 5-pin cylinder with spool pins
- Standard non-key retaining
- Includes optional key retaining hardware

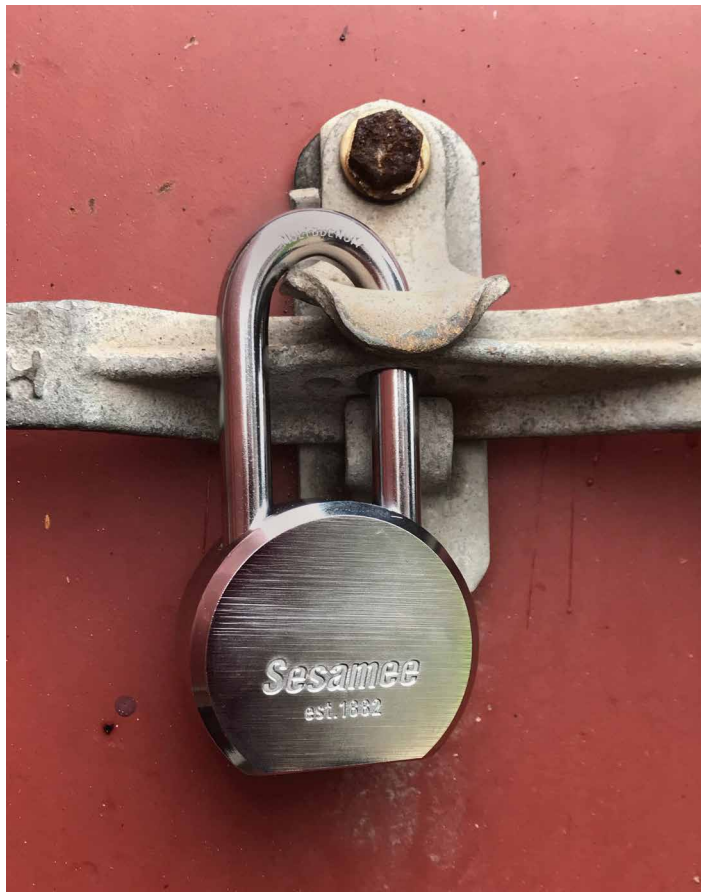
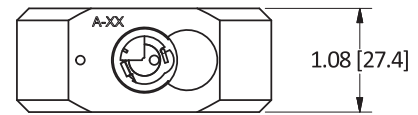
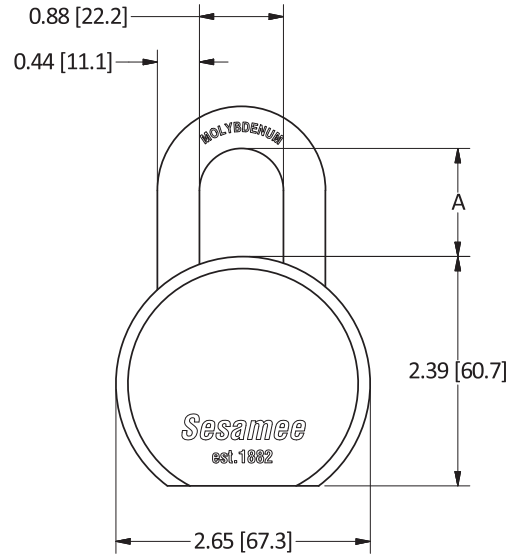

93601
93602

93701
93702



93701
93702

93701
93702

637 | 646 SERIES COMBINATION PADLOCKS

4 - DIAL RESETTABLE HEAVY-DUTY SUPER SESAMEE

PART #	SHACKLE CLEARANCE	FINISH	PACKAGING	SHELF PACK	MASTER CARTON
K637	2"	Black	Visual	5	20
K646	1"	Black	Visual	5	20

BEST USED FOR: INDUSTRIAL | COMMERCIAL

Job boxes & gang boxes | Utility meters, substations & cable boxes
Tool chests, boxes & cribs | Lockers

- Industrial strength combination lock
- 10,000 possible combinations
- Hardened steel, full metal jacket and shroud
- Weather-resistant black electrocoat
- Chrome-plated molybdenum shackle
- Shackle pull strength: 2,750 lbs [1247 kg]
- All-brass internal mechanism, including dials
- Resetting tool included

See next page (10) for product photos.

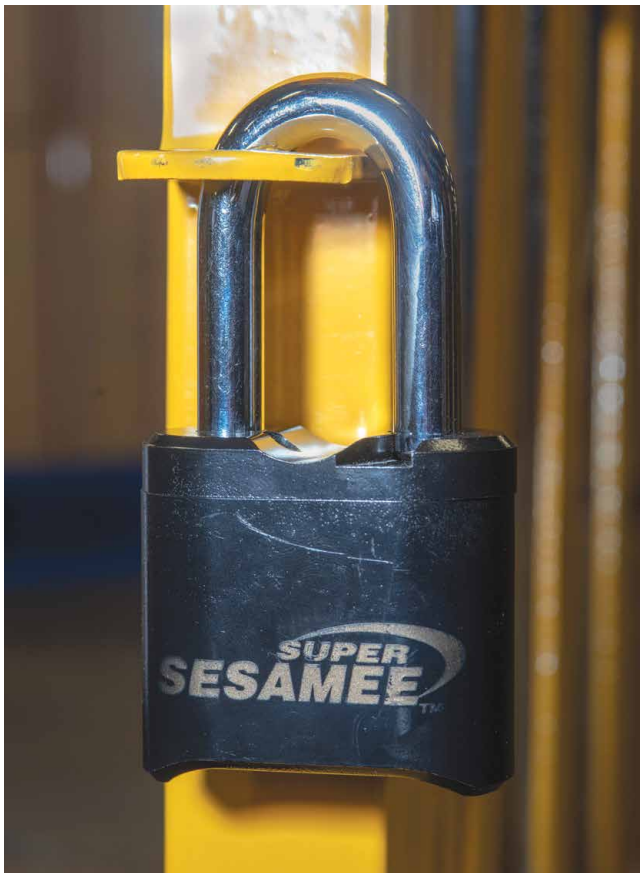
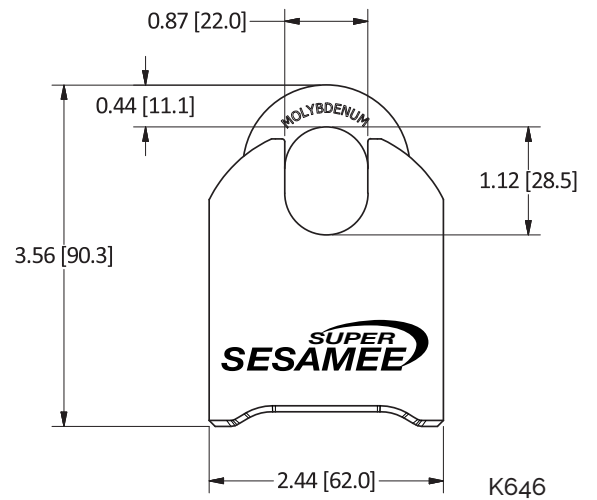
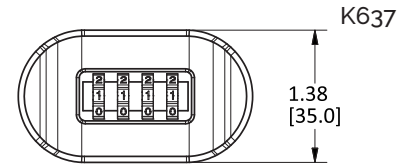
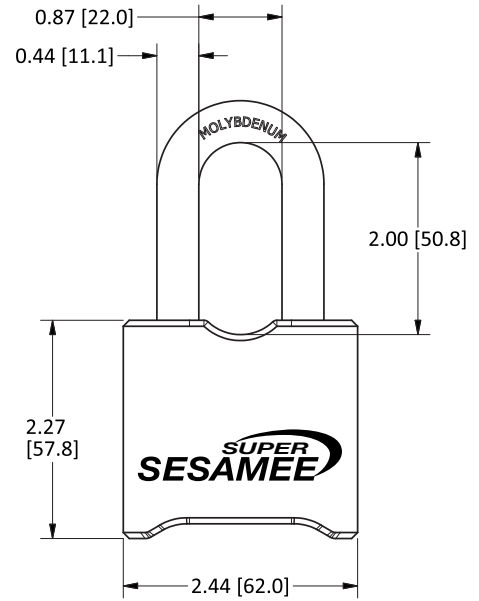

K637

637 | 646 SERIES COMBINATION PADLOCKS

4 - DIAL RESETTABLE HEAVY-DUTY SUPER SESAMEE



K637



K646



930 SERIES PUCK LOCKS

HIDDEN SHACKLE PADLOCK

PART #	BACK	BODY MATERIAL	KEYED	PACKAGING	SHELF PACK	MASTER PACK
93001	Stepped	Hardened Steel	KA	Boxed	4	12
93002-Z	Stepped	Zinc Diecast	KD	Boxed	4	12
93005	Flat Back	Hardened Steel	KA	Boxed	4	12
93006	Flat Back	Hardened Steel	KD	Boxed	4	12
930SFIC	Flat Back	Hardened Steel	SFIC	Boxed	4	12
930KIK	Flat Back	Hardened Steel	KIK	Boxed	4	12
930-Dial	Stepped	Hardened Steel	Dial	Boxed	4	12

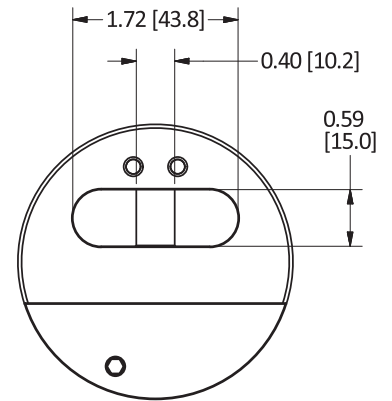
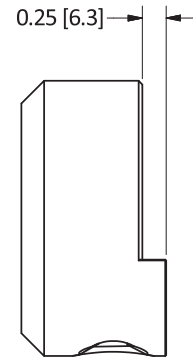
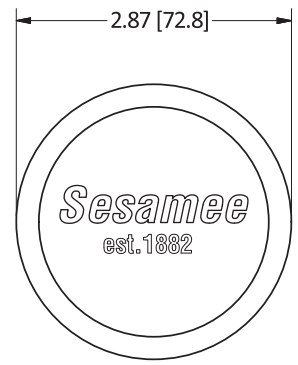

BEST USED FOR: INDUSTRIAL | COMMERCIAL

- Hardened steel, chrome-plated body
- Boron alloy shackle
- Rekeyable 5-pin cylinder with spool pins
- 930SFIC & 930KIK Housings only; cores are not included



930-Dial



93005
93006



93001

960 SERIES SECURITY BOXES

DIAL COMBINATION

PART #	SHACKLE CLEARANCE	TYPE	PACKAGING	SHELF PACK	MASTER CARTON
96008	None	Wall Mount	Blister Pack	10	20
96009	1.96"	Over-the-Door	Blister Pack	10	20

BEST USED FOR: RESIDENTIAL | RETAIL

Primary Home, Timeshare, Vacation Properties | Storage, Shed
Recreation Vehicles: Bicycle, ATV, Boat

- Convenient, easy-to-set and reset combination
- Select who can access your property by placing keys in locked box and sharing padlock combination
- Holds door or car keys, cavity size (1" x 2.75" x 2.25") [25mm x 70mm x 57mm]
- Durable metal construction
- Vinyl-coated body and shackle
- Shutter door protects combination dials from weather, dirt, and grime

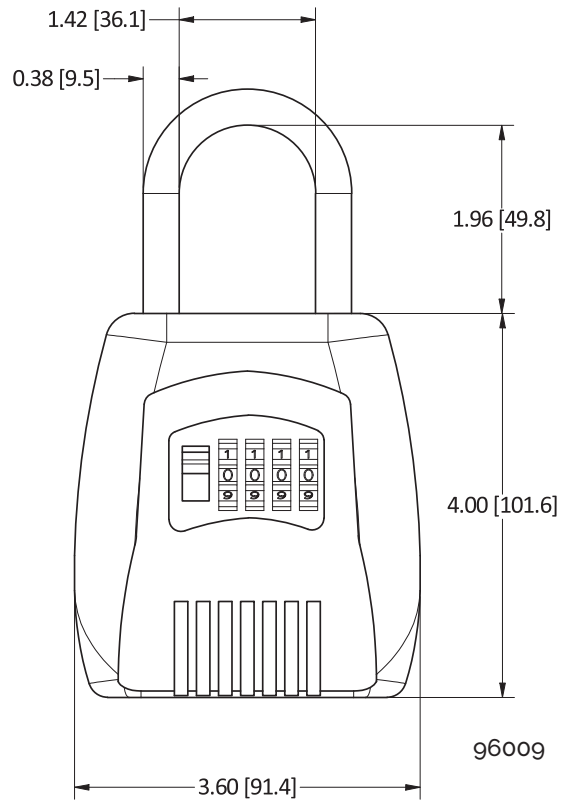
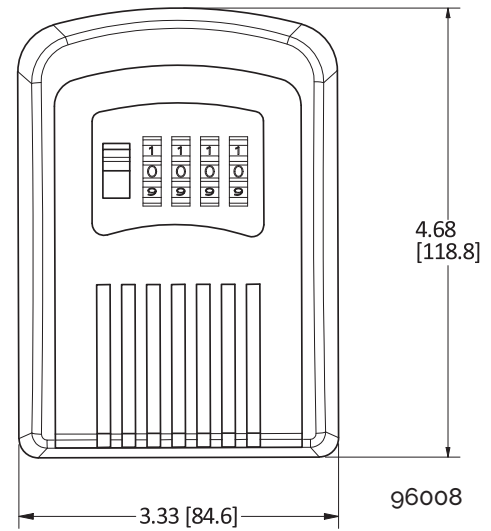

96009



96008



96008

U - LOCKS

REMOVABLE CORE LARGE SHACKLE PADLOCK

PART #	SHACKLE CLEARANCE	FINISH	PACKAGING
BKL852-9X4	4.25 x 9.125"	Black	Visual

BEST USED FOR: BICYCLES | SCOOTERS

- Removable locking core
- Double-bitted reversible key
- Hardened steel shackle
- Hardened cross bar

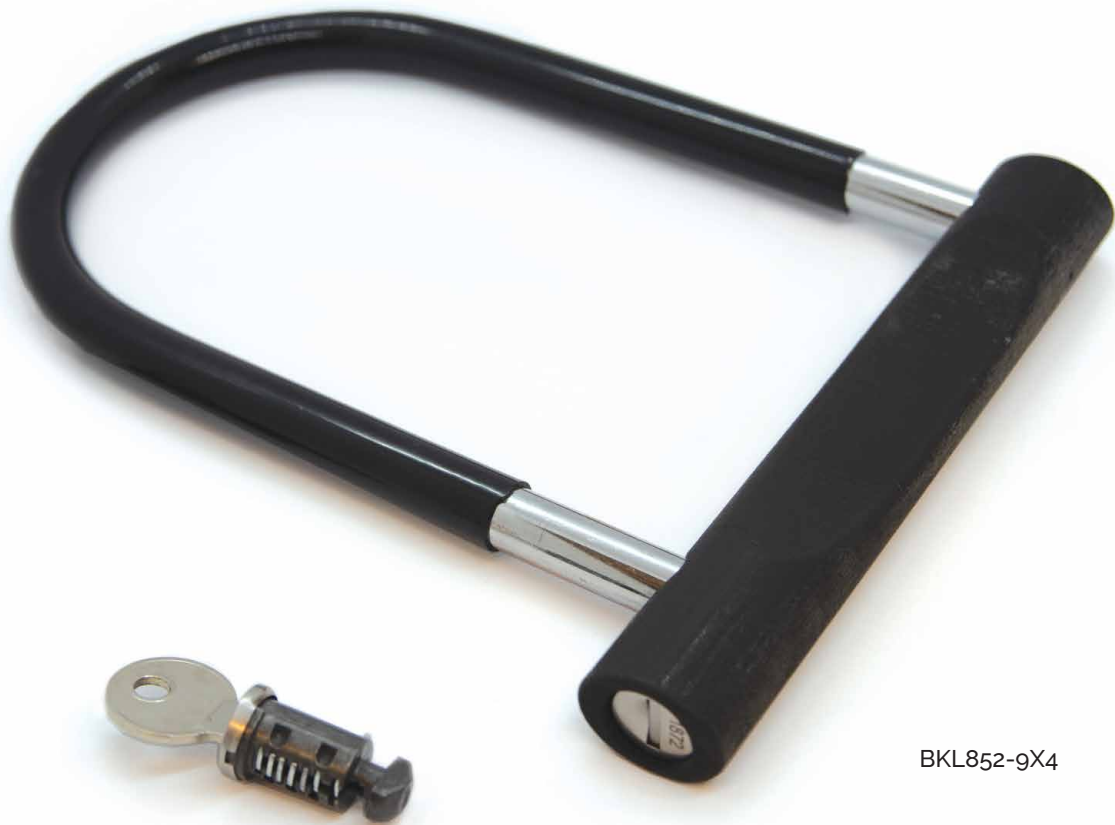
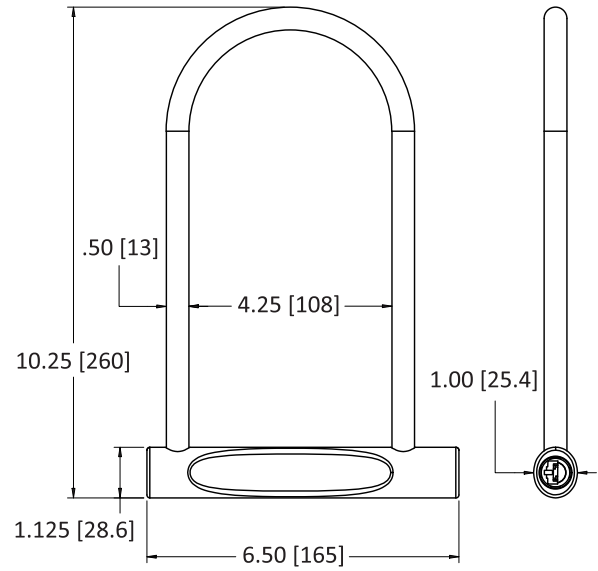

BKL852-9X4

HITCH PINS

RECEIVER LOCKING PIN

PART #	SHAFT DIAMETER (A)	FINISH	PACKAGING
HPL850-0500	.5"	Brass	Visual
HPL850-0625	.625"	Brass	Visual

BEST USED FOR: VEHICLES | TRAILERS

- Removable locking core
- Double-bitted reversible key
- Hardened steel locking pin
- Brass lock body
- Flip dust cover

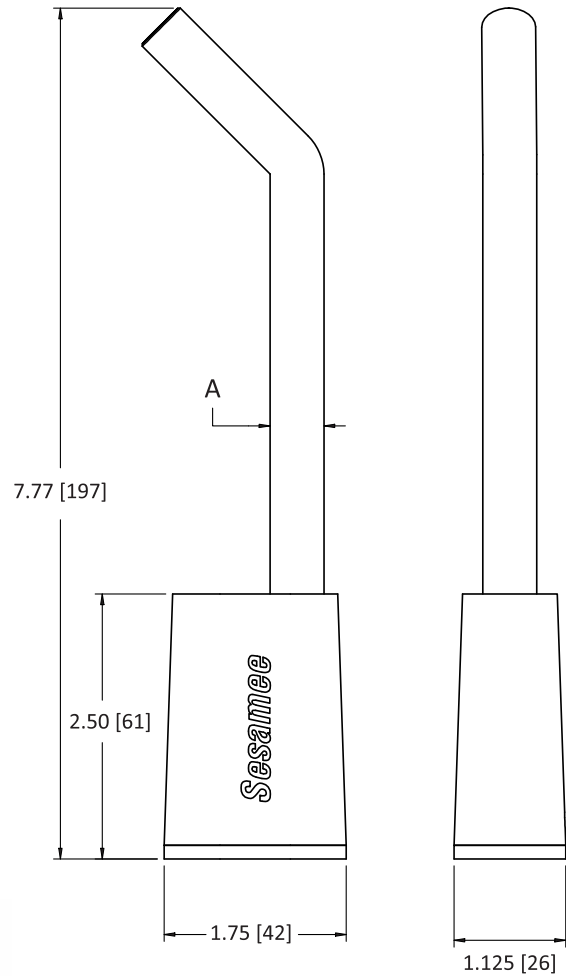

HPL850-0500

CONVERSION CHARTS

FRACTION	INCHES	MM	FRACTION	INCHES	MM
1/32	.0312	0.79	17/32	.5312	13.49
1/16	.0625	1.58	9/16	.5625	14.28
3/32	.0937	2.38	19/32	.5937	15.08
1/8	.1250	3.17	5/8	.6250	15.87
5/32	.1562	3.97	21/32	.6562	16.66
3/16	.1875	4.76	11/16	.6875	17.46
7/32	.2187	5.55	23/32	.7187	18.25
1/4	.25	6.35	3/4	.75	19.05
9/32	.2812	7.14	25/32	.7812	19.84
5/16	.3125	7.93	13/16	.8125	20.63
11/32	.3437	8.73	27/32	.8437	21.43
3/8	.3750	9.52	7/8	.8750	22.22
13/32	.4062	10.31	29/32	.9062	23.01
7/16	.4375	11.11	15/16	.9375	23.81
15/32	.4687	11.90	31/32	.9687	24.60
1/2	.5	12.70	1	1.00	25.40

Equivalents:
 1 in = 2.54 cm
 1 cm = .3937 in

NB: All drawing measurements shown are to be used for reference only. Please contact your local Eberhard sales representative for detailed specification drawing if required.

TO CONVERT	INTO	MULTIPLY BY	TO CONVERT	INTO	MULTIPLY BY
FEET	INCHES	12	METERS	INCHES	39.37
FEET	MILLIMETERS	304.8	METERS	FEET	3.281
FEET	METERS	0.3048	MILLIMETERS	METERS	0.001
FOOT-POUNDS	NEWTON-METERS	1.356	MILLIMETERS	INCHES	0.03937
INCHES	MILLIMETERS	25.4	MILLIMETERS	FEET	0.003281
INCHES	METERS	0.0254	NEWTONS	KILOGRAMS (FORCE)	0.102
INCHES	FEET	0.08333	NEWTONS	POUNDS (FORCE)	0.2248
INCH-POUNDS	NEWTON-METERS	0.113	NEWTON-METERS	INCH-POUNDS	8.851
KILOGRAMS (FORCE)	NEWTONS	9.807	NEWTON-METERS	FOOT-POUNDS	0.7376
KILOGRAMS (MASS)	POUNDS (MASS)	2.205	POUNDS (MASS)	KILOGRAMS (MASS)	0.4536
METERS	MILLIMETERS	1000	POUNDS (FORCE)	NEWTONS	4.448

CONTACT US

21944 Drake Road | Strongsville, OH 44149-9712 | 800-334-6706

eberhard.com | sales@eberhard.com



EBERHARD®

PRODUCT CATALOG 2019

21944 Drake Road | Strongsville, OH 44149-9712 | 800-334-6706 | eberhard.com | sales@eberhard.com | 7.19